

SURVEYOR'S OFFICE

Hamilton County

Kenton C. Ward, CFM
Surveyor of Hamilton County
Phone (317) 776-8495
Fax (317) 776-9628

Suite 188
One Hamilton County Square
Noblesville, Indiana 46060-2230

March 1, 2016

To: Hamilton County Drainage Board

Re: Little Eagle Creek Drain, Maple Knoll Section 8 Arm

Attached is a petition filed by Maple Knoll Developer, LLC, along with a non-enforcement request, plans, calculations, quantity summary and assessment roll for the Maple Knoll Section 8 Arm, Little Eagle Creek Drain to be located in Washington Township. I have reviewed the submittals and petition and have found each to be in proper form.

I have made a personal inspection of the land described in the petition. Upon doing so, I believe that the drain is practicable, will improve the public health, benefit a public highway, and be of public utility and that the costs, damages and expenses of the proposed drain will probably be less than the benefits accruing to the owners of land likely to be benefited. The drain will consist of the following:

12" RCP	116 ft.	15" RCP	447 ft.
18" RCP	169 ft.	6" SSD	5,222 ft.

The total length of the drain will be 5,954 feet.

The subsurface drains (SSD) to be part of the regulated drain are those located under the curbs and those main lines in rear yards. Only the main SSD lines which are located within the easement or right of way are to be maintained as regulated drain. Laterals for individual lots will not be considered part of the regulated drain. The portion of the SSD which will be regulated other than those under curbs are as follows:

Curbline SSD in Streets:

Morley Lane
 Burgess Hill Pass
 Connolly Drive

Rear Yard SSDs:

Rear yard lots 456 to 463 from ex. Str. 352 to ex. Str. 330
 Rear yard lots 464 to 468 from Str. 344 running east to riser
 Rear yard lot 468 from Str. 344 running west & north to riser
 Rear yard lots 439 and 440 from Str. 324 running south to riser
 Rear yard lots 470 to 474 from Str. 327A running north to riser

I have reviewed the plans and believe the drain will benefit each lot equally. Therefore, I recommend each lot be assessed equally. I also believe that no damages will result to landowners by the construction of this drain. I recommend a maintenance assessment of \$65.00 per platted lot, \$10.00 per acre for common areas, with a \$65.00 minimum, and \$10.00 per acre for roadways. With this assessment the total annual assessment for this drain will be \$2,535.10.

In accordance with IC 36-7-4-709, the petitioner did not submit surety for the proposed drain prior to construction commencing. If the petitioner/developer wants to submit final secondary plat for recording prior to the final inspection and approved as-built drawings, a bond will be required at that time.

I believe this proposed drain meets the requirements for Urban Drain Classification as set out in IC 36-9-27-67 to 69. Therefore, this drain shall be designated as an Urban Drain.

I recommend that upon approval of the above proposed drain that the Board also approve the attached non-enforcement requests. The request will be for the reduction of the regulated drain easement to those easement widths as shown on the secondary plats for Maple Knoll Section 8 as recorded in the office of the Hamilton County Recorder.

I recommend the Board set a hearing for this proposed drain for April 25, 2016.

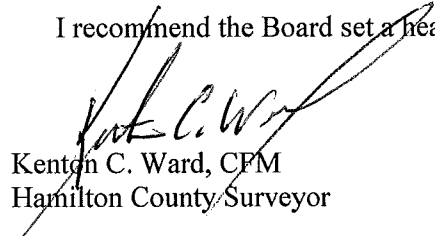

Kenton C. Ward, CFM
Hamilton County Surveyor

KCW/pll

(Revised 06/08/04)

STATE OF INDIANA)
)
COUNTY OF HAMILTON)

FILED

OCT 26 2015

TO: HAMILTON COUNTY DRAINAGE BOARD
% Hamilton County Surveyor
One Hamilton County Square, Suite 188
Noblesville, IN. 46060-2230

OFFICE OF HAMILTON COUNTY SURVEYOR

In the matter of Maple Knoll Subdivision, Section
Section 8 Drain Petition.

Petitioner is the owner of all lots in the land affected by the proposed new regulated drain. The drainage will affect various lots in Maple Knoll, Section 8, a subdivision in Hamilton County, Indiana. The general route of such drainage shall be in existing easements and along public roads as shown in the plans on file in the Surveyor's Office.

Petitioner believes that the cost, damages and expenses of the proposed improvement will be less than the benefits which will result to the owners of the land likely to be benefited thereby. Petitioner believes the proposed improvements will:

- (a) improve public health
- (b) benefit a public street
- (c) be of public utility

Petitioner agrees to pay the cost of construction of the drainage system and requests periodic maintenance assessments by the Board thereafter.

The Petitioner also agrees to the following:

1. To provide the Drainage Board a Performance Bond or Non-Revocable Letter of Credit for the portion of the drainage system which will be made a regulated drain. The bond will be in the amount of 120% of the Engineer's estimate. The bond will be in effect until construction of 100% of the system is completed and so certified by the Engineer.
2. The Petitioner shall retain an Engineer throughout the construction phase. At completion of the project the Petitioner's Engineer shall certify that the drainage system which is to be maintained as a regulated drain has been constructed as per construction plans.
3. The Petitioner agrees to request in writing to the County Surveyor any changes from the approved plan and must receive written authorization from the County Surveyor prior to implementation of the change. All changes shall be documented and given to the Surveyor to be placed in the Drain file.
4. The Petitioner shall instruct his Engineer to provide a reproducible print on a 24" x 36" Mylar of the final design of the Drainage System. This shall be submitted to the County Surveyor prior to the release of the Performance Bond.
5. The Petitioner shall comply with the Erosion Control Plan as specified on the construction plans. Failure to comply with the Erosion Control Plan shall be determined by the Board as being an obstruction to the drainage system. The County Surveyor shall immediately install or repair the needed measures at Petitioners cost as per IC 36-9-27-46.

Adobe PDF Fillable Form

The Petitioner further requests that the Drain be classified as an Urban Drain as per IC 36-9-27-69(d).

RECORDED OWNER(S) OF LAND INVOLVED

Signed

Timothy J. Walter
Printed Name

October 20, 2015
Date

Signed

Printed Name

Date

Signed

Printed Name

Date

Signed

Printed Name

Date

FINDINGS AND ORDER

CONCERNING THE MAINTENANCE OF THE

Little Eagle Creek Drain, Maple Knoll Section 8 Arm

On this 25th day of April, 2016, the Hamilton County Drainage Board has held a hearing on the Maintenance Report and Schedule of Assessments of the *Little Eagle Creek Drain, Maple Knoll Section 8 Arm*.

Evidence has been heard. Objections were presented and considered. The Board then adopted the original/amended Schedule of Assessments. The Board now finds that the annual maintenance assessment will be less than the benefits to the landowners and issues this order declaring that this Maintenance Fund be established.

HAMILTON COUNTY DRAINAGE BOARD

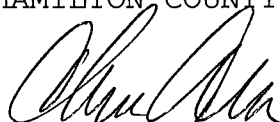

President

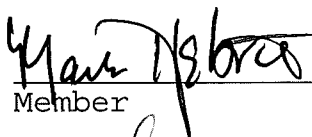

Member

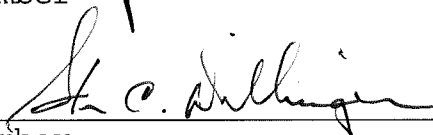

Member

Attest:

Executive Secretary



FILED

JAN 29 2016

OFFICE OF HAMILTON COUNTY SURVEYOR

Maple Knoll Section 8
 Engineers Estimate - Storm Sewers & Monumentation
 Prepared on: 1.22.2016

Item	Unit	Unit Cost	Quantities	Cost
Storm Drainage				
12" Pipe	LF	\$ 24.50	116	\$ 2,842
15" Pipe	LF	\$ 28.70	447	\$ 12,829
18" Pipe	LF	\$ 33.60	169	\$ 5,678
Standard Storm Manholes	EA	\$ 2,775.00	1	\$ 2,775
Storm Inlets	EA	\$ 3,000.00	8	\$ 24,000
Sand Backfill and Bedding	TON	\$ 14.50	140.00	\$ 2,030
Subtotal 1				\$ 50,154
Sub-surface Drains - under curb	LF	\$ 7.50	3,800	\$ 32,594
Sub-surface Drains - swales	LF	\$ 7.75	2,082	\$ 12,547
Sub-surface Drains - sump laterals	EA	\$ 167.00	41	\$ 6,188
Subtotal 2				\$ 51,329
Total				\$ 101,484
Monuments & Markers				
Lot Corner Monuments	LOT	\$ 100.00	36.00	\$ 3,600
Street Centerline Monumentation	EA	\$ 170.00	2.00	\$ 340
Total				\$ 3,940
Erosion Control	LS	NA	NA	NA
--> Not Applicable - Property annexed by City of Westfield and governed by Westfield MS4 permit.				
Total				\$ -
Grand Total				\$ 105,424
Per Hamilton County Ordinance - Bond Amount				120% \$ 126,508

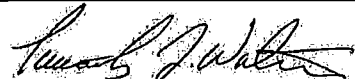
BY: 

Timothy J. Walter, P.E.
 Indiana Registration No. 19900152

317 818-2900 ♦ 317 863-2055 fax

9757 Westpoint Drive, Suite 600 ♦ Indianapolis, IN 46256

BEFORE THE HAMILTON COUNTY DRAINAGE BOARD
IN THE MATTER OF

Little Eagle Creek Drain, Maple Knoll Section 8 Arm

NOTICE

To Whom It May Concern and: _____

Notice is hereby given of the hearing of the Hamilton County Drainage Board on the **Little Eagle Creek Drain, Maple Knoll Section 8 Arm** on **April 25, 2016** at **9:00 A.M.** in Commissioners Court, Hamilton County Judicial Center, One Hamilton County Square, Noblesville, Indiana, and which construction and maintenance reports of the Surveyor and the Schedule of Assessments made by the Drainage Board have been filed and are available for public inspection in the office of the Hamilton County Surveyor.

Hamilton County Drainage Board

Attest: Lynette Mosbaugh

ONE TIME ONLY

BEFORE THE HAMILTON COUNTY DRAINAGE BOARD
IN THE MATTER OF THE

Little Eagle Creek Drain, Maple Knoll Section 8 Arm

NOTICE

Notice is hereby given pursuant to Section 405 of the 1965 Indiana Drainage Code that this Board, prior to final adjournment on **April 25, 2016** has issued an order adopting the Schedule of Assessments, filed the same and made public announcement thereof at the hearing and ordered publication. If judicial review of the findings and order of the Board is not requested pursuant to Article Eight of this code within twenty (20) days from the date of this publication, the order shall be conclusive.

Hamilton County Drainage Board

Attest: Lynette Mosbaugh

ONE TIME ONLY

KCW

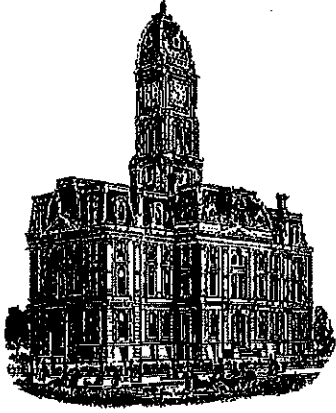

SURVEYOR'S OFFICE
Hamilton County

Kenton C. Ward, CFM
Surveyor of Hamilton County
Phone (317) 776-8495
Fax (317) 776-9628

Suite 188
One Hamilton County Square
Noblesville, Indiana 46060-2230

To: Hamilton County Drainage Board

May 24, 2017

Re: Little Eagle Creek Drain: Maple Knoll Section 8

Attached are as-built, certificate of completion & compliance, and other information for Maple Knoll Section 8. An inspection of the drainage facilities for this section has been made and the facilities were found to be complete and acceptable.

During construction, changes were made to the drain, which will alter the plans submitted with my report for this drain-dated March 1, 2016. The report was approved by the Board at the hearing held April 25, 2016. (See Drainage Board Minutes Book 16, Pages 518-519) The changes are as follows: the 15" RCP was shortened from 447 feet to 444 feet. The 18" RCP was shortened from 169 feet to 168 feet. The 6" SSD was shortened from 5,222 feet to 5,201 feet. The length of the drain due to the changes described above is now **5,929 feet**.

The non-enforcement was approved by the Board at its meeting on April 25, 2016 and recorded under instrument #2017000901. Sureties were not provided by the developer in accordance with IC 36-9-27-67 to 69.

I recommend the Board approve the drain's construction as complete and acceptable.

Sincerely,

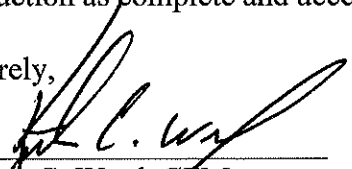

Kenton C. Ward, CFM
Hamilton County Surveyor

CERTIFICATE OF COMPLETION AND COMPLIANCE

To: Hamilton County Surveyor

Re: Maple Knoll, Section 8

I hereby certify that:

1. I am a Registered Land Surveyor or Engineer in the State of Indiana.
2. I am familiar with the plans and specifications for the above referenced subdivision.
3. I have personally observed and supervised the completion of the drainage facilities for the above referenced subdivision.
4. The drainage facilities within the above referenced subdivision to the best of my knowledge, information and belief have been installed and completed in conformity with all plans and specifications.
5. The drainage facilities within the above referenced subdivision to the best of my knowledge, information and belief have been correctly represented on the Record Drawings, Digital Record Drawings and the Structure Data Spreadsheet.

Signature: David J. Stoepelwerth Date: December 15, 2016

Type or Print Name: David J. Stoepelwerth

Business Address: Stoepelwerth & Associates, Inc.

7965 East 106th Street, Fishers, Indiana 46038

Telephone Number: (317) 849-5935

SEAL



INDIANA REGISTRATION NUMBER

19358

MAPLE KNOLL

SECTION 8

RECORD DRAWING

Developed by:
MAPLE KNOLL DEVELOPER, LLC by
Platinum Properties Management Company, LLC
9757 Westpoint Drive Suite 600
Indianapolis, Indiana 46256
Phone: (317) 863-2057
Contact Person: Tim Walter

Dennis D. Olmstead
 Dennis D. Olmstead
 Registered Land Surveyor
 No. 900012

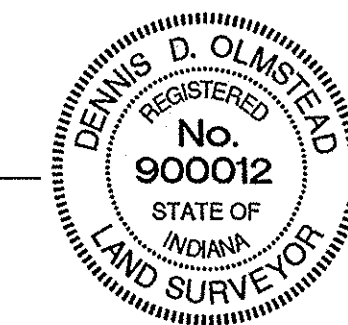

UTILITY CONTACTS

- AT & T**
 5858 North College Ave.
 Indianapolis, Indiana 46220
 Contact: Michael Hayes
 Ph: (317) 252-4007
- Frontier Communications**
 20905 Hague Road (Rear Building)
 Noblesville, Indiana 46060
 Contact: Steve Costlow
 Ph: (317) 984-9010
- Comcast Cable**
 5330 East 65th Street
 Indianapolis, Indiana 46220
 Contact: Matt Stringer
 Ph: (317) 774-3384
- Vectren Energy**
 16999 Allisonville Road
 Noblesville, Indiana 46060
 Contact: Charlotte May
 Ph: (317) 776-5592
- Duke Energy**
 16475 Southpark Drive
 Westfield, Indiana 46074
 Contact: Shirley Hunter
 Ph: (317) 896-6711
- Brighthouse Networks**
 3030 Roosevelt Ave.
 Indianapolis, Indiana 46218
 Contact: Gary Richardson
 Ph: (317) 632-9077
- Citizens Wastewater of Westfield, LLC**
 2150 Dr. Martin Luther King Jr. Street
 Indianapolis, Indiana 46202
 Contact: Ryan Taylor
 Ph: (317) 917-6053
- Citizens Water of Westfield, LLC**
 2150 Dr. Martin Luther King Jr. Street
 Indianapolis, Indiana 46202
 Contact: Ryan Taylor
 Ph: (317) 917-6053
- Westfield Public Works Department**
 2706 East 171st Street
 Westfield, Indiana 46074
 Contact: Jeremy Lollar
 Ph: (317) 804-3100

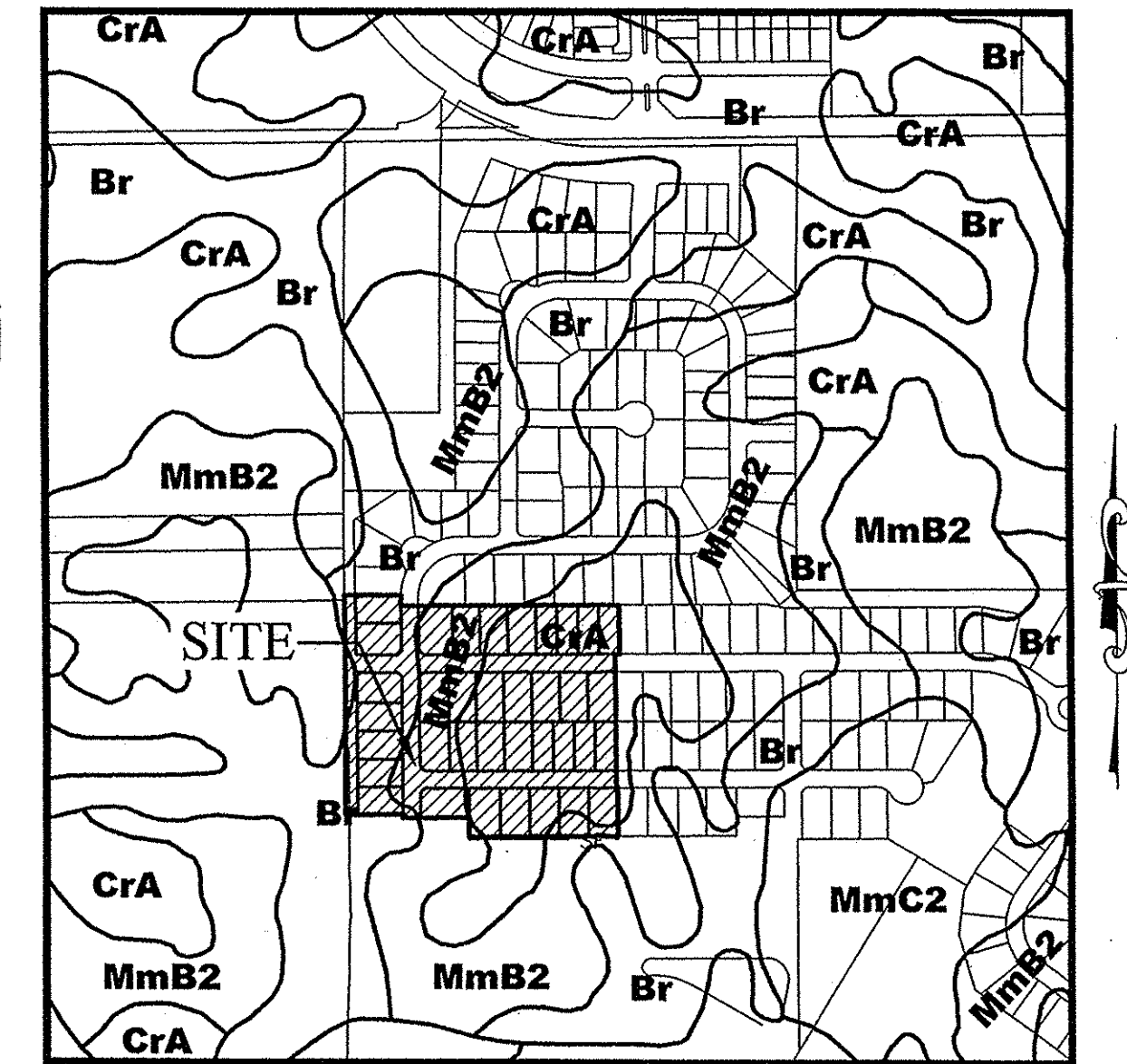

Map Unit: Br - Brookston silty clay loam
 Br-Brookston silty clay loam
 This poorly drained soil has a seasonal high water table above the surface or within 1.0 ft. and is in depressions. Slopes are 0 to 2 percent. The native vegetation is water tolerant grasses and hardwoods. The surface layer is silty clay loam and has moderate or high organic matter content (2.0 to 5.0 percent). Permeability is moderately slow (0.2 to 0.6 in/hr) in the most restrictive layer above 60 inches. Available water capacity is high (10.0 inches in the upper 60 inches). The pH of the surface layer in non-limed areas is 6.1 to 7.3. This soil is hydric. Wetness is a management concern for crop production. This soil responds well to tile drainage.

Map Unit: CrA - Crosby silt loam, 0 to 2 percent slopes
 CrA-Crosby silt loam, 0 to 2 percent slopes
 This is a somewhat poorly drained soil and has a seasonal high water table at 0.5 to 2.0 ft. and is on rises on uplands. Slopes are 0 to 2 percent. The native vegetation is hardwoods. The surface layer is silt loam and has moderately low or moderate organic matter content (1.0 to 3.0 percent). Permeability is very slow (< 0.06 in/hr) in the most restrictive layer above 60 inches. Available water capacity is moderate (6.2 inches in the upper 60 inches). The pH of the surface layer in non-limed areas is 5.1 to 6.0. Droughtiness and wetness are management concerns for crop production. This soil responds well to tile drainage.

Map Unit: MmB2 - Miami silt loam, 2 to 6 percent slopes, eroded
 MmB2-Miami silt loam, 2 to 6 percent slopes, eroded
 This moderately well drained soil has a seasonal high water table at 2.0 to 3.5 ft. and is on sideslopes and rises on uplands. Slopes are 2 to 6 percent. The native vegetation is hardwoods. The surface layer is silt loam and has moderately low organic matter content (1.0 to 2.0 percent). Permeability is very slow (< 0.06 in/hr) in the most restrictive layer above 60 inches. Available water capacity is low (5.9 inches in the upper 60 inches). The pH of the surface layer in non-limed areas is 5.1 to 6.0. Droughtiness and water erosion are management concerns for crop production.

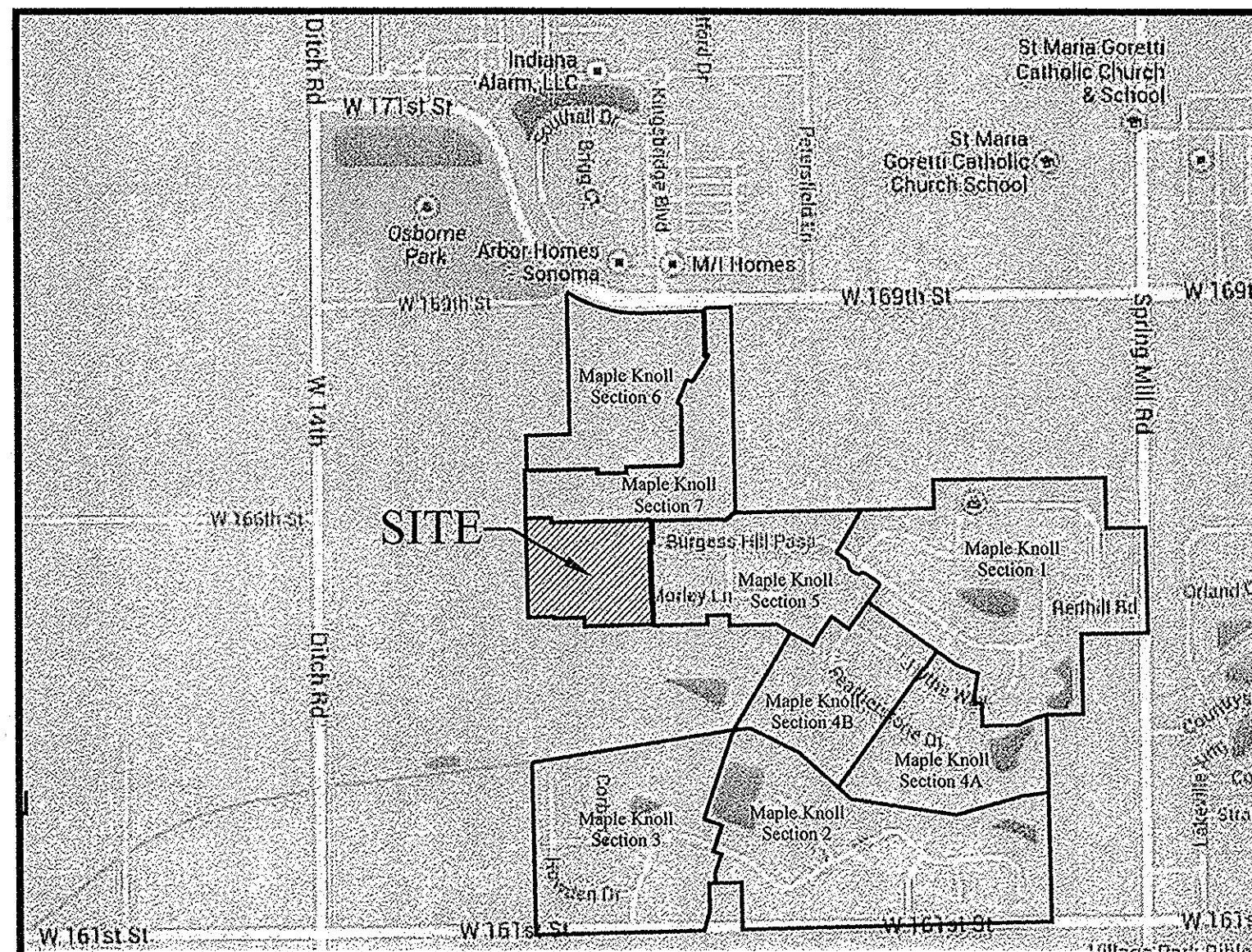

LOCATION MAP
 SCALE: 1"=1000'

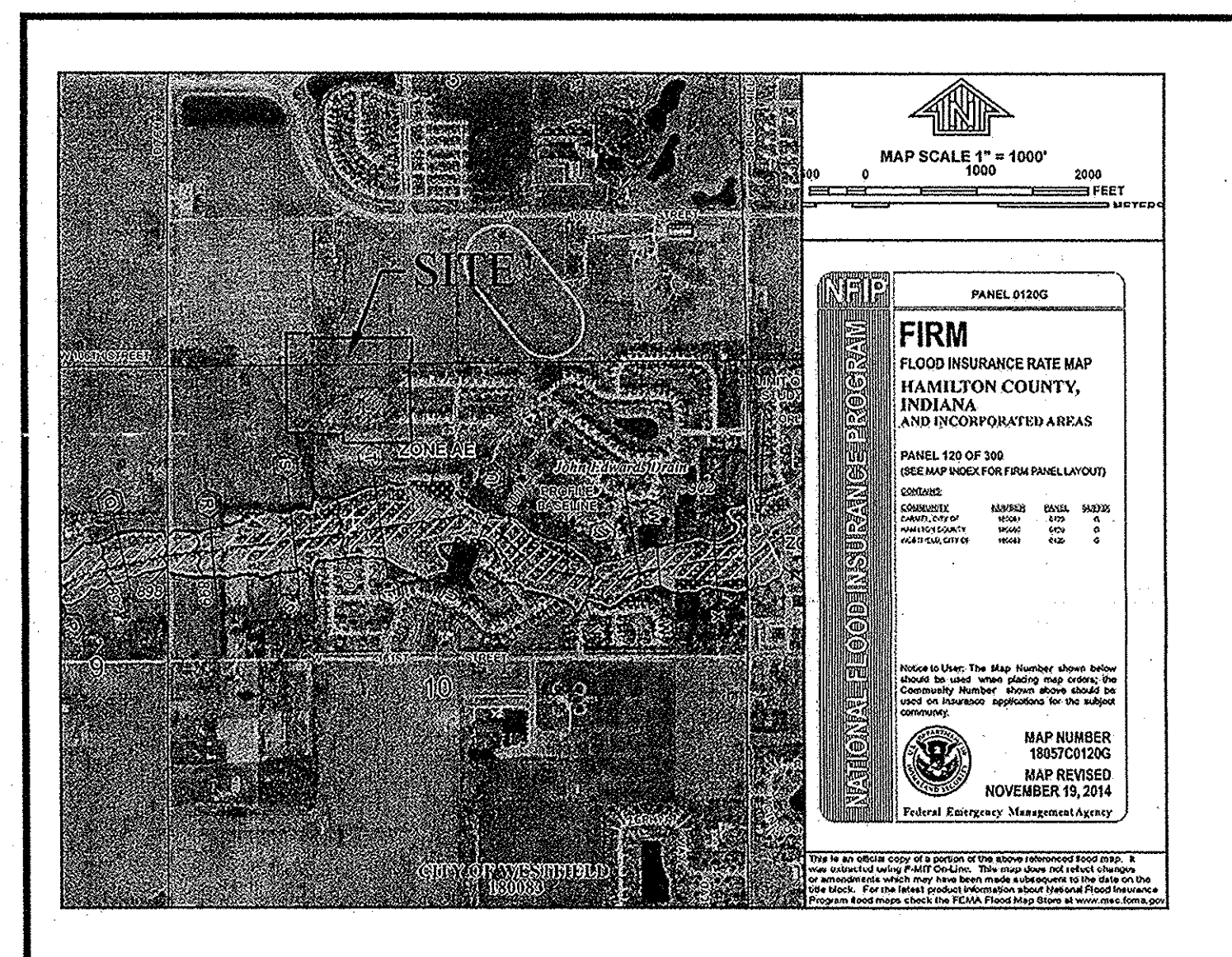

FLOOD MAP
 N.T.S.

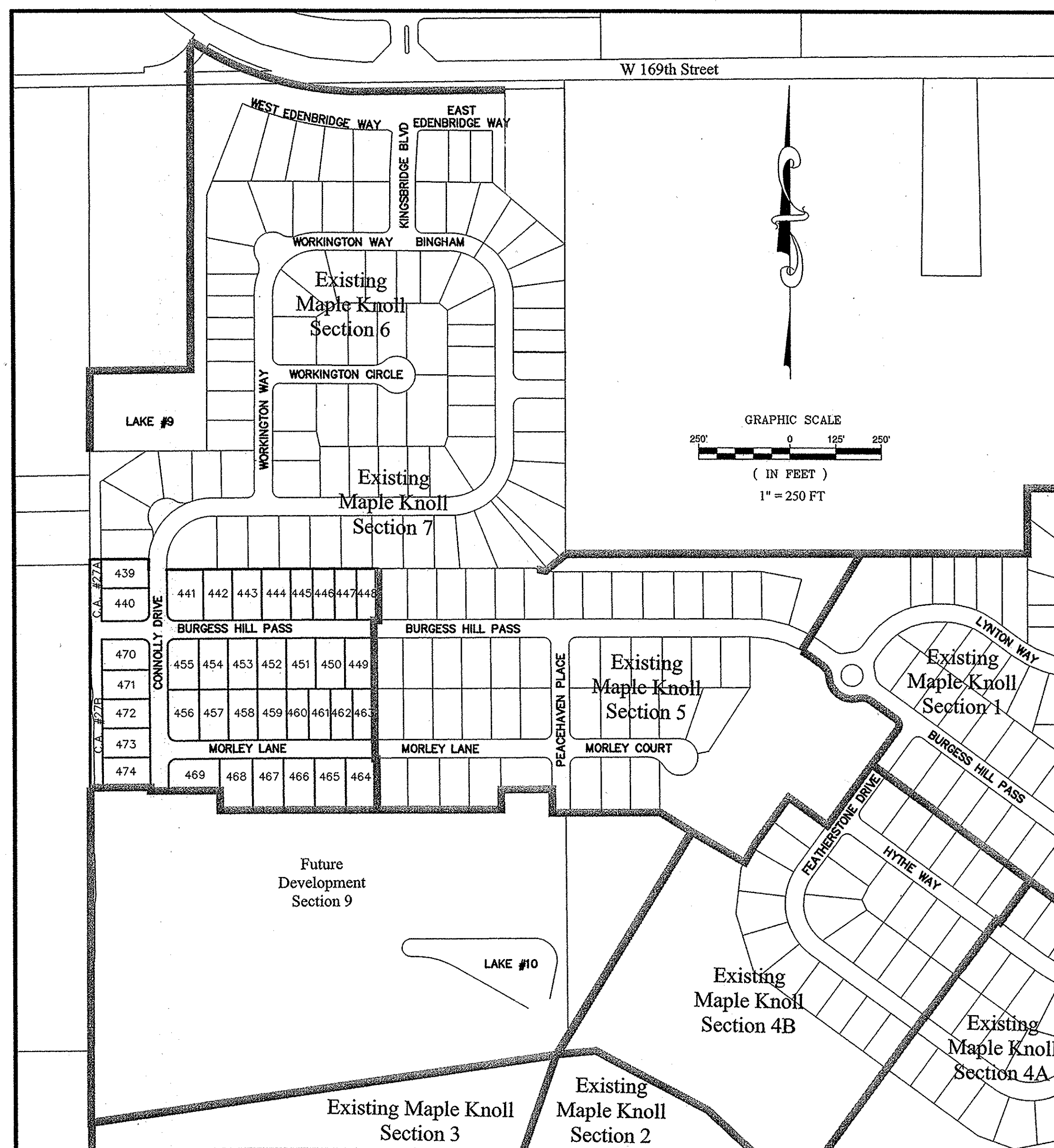

INDIANA DEPARTMENT OF TRANSPORTATION STANDARD SPECIFICATIONS LATEST EDITION TO BE USED WITH THESE PLANS UNLESS ALTERNATE SPECIFICATIONS ARE SHOWN WITHIN.

WESTFIELD CONSTRUCTION STANDARD DETAILS AND SPECIFICATIONS LATEST EDITIONS TO BE USED WITH THESE PLANS.

ALL CONTRACTORS SHALL REVIEW CITY OF WESTFIELD STANDARDS AND SPECIFICATIONS PRIOR TO BIDDING ON THIS PROJECT. ADDITIONAL SPECIFICATIONS, NOT INCLUDED IN THIS SET OF PLANS, MAY BE REQUIRED. <http://www.westfield.in.gov/egov/apps/document/center.egov?view=itemid=50>

THE PRESENCE OF A CITY OF WESTFIELD REVIEW AND ACCEPTANCE STAMP ON PLANS DOES NOT RELIEVE THE CONTRACTOR OR DEVELOPER FROM COMPLIANCE OF THE "CITY OF WESTFIELD CONSTRUCTION STANDARDS, LATEST EDITION". THIS REVIEW ONLY DESIGNATES THAT THE GENERAL CONFORMANCE WITH DESIGN AND SPECIFICATIONS HAVE BEEN MET. FIELD CHANGES MAY BECOME NECESSARY IN ORDER TO COMPLY WITH THE DETAILED CITY OF WESTFIELD SPECIFICATIONS.

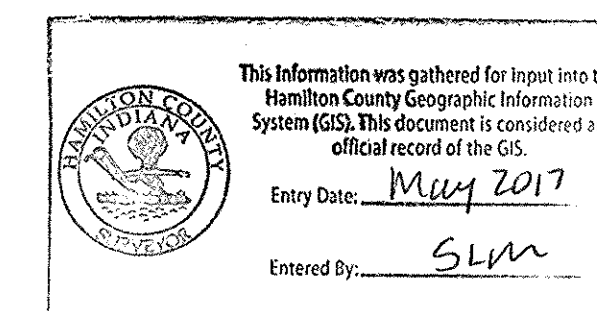

PLANS PREPARED BY:
STOEPPELWERTH & ASSOCIATES, INC.
 CONSULTING ENGINEERS & LAND SURVEYORS
 7965 E. 106TH STREET, FISHERS, INDIANA 46038
 PHONE: (317)-849-5935
 FAX: (317)-849-5942
 CONTACT PERSON: BRIAN K. ROBINSON
 EMAIL: brobinson@Stoepfelwerth.com

PLANS CERTIFIED BY:

David J. Stoepfelwerth 9/27/14
 DAVID J. STOEPPELWERTH
 PROFESSIONAL LAND SURVEYOR
 No. 19358

INDEX	
SHT.	DESCRIPTION
C001	COVER SHEET
C100	TOPOGRAPHICAL SURVEY
C200-C201	SITE DEVELOPMENT PLAN/SITE PLAN
C300-C305	INITIAL STORM WATER POLLUTION & PREVENTION PLAN TEMPORARY STORM WATER POLLUTION & PREVENTION PLAN PERMANENT SEDIMENT & EROSION CONTROL PLAN STORM WATER POLLUTION & PREVENTION SPECIFICATIONS STORM WATER POLLUTION & PREVENTION DETAILS
C400-C404	STREET PLAN & PROFILES TRAFFIC CONTROL PLAN INTERSECTION DETAILS
C500-C501	SANITARY SEWER PLAN & PROFILE
C600-C602	STORM SEWER PLAN & PROFILES
C700-C701	WATER PLAN WATER DETAILS
C800-C805	CONSTRUCTION DETAILS SANITARY STORM STREET
C901-C903	LANDSCAPE PLANS

REVISIONS	
SHT.	DESCRIPTIONS
ALL	REVISED PER TAC COMMENTS 10/19/15 KJMJ
ALL	REVISED PER CITIZENS WATER & SANITARY 11/16/15 DCM
ALL	REVISED PER TAC COMMENTS 12/02/15 GEM
ALL	ADDED 6' ASPHALT PATH 12/10/15 DCM
ALL	REVISED PER CITY OF WESTFIELD COMMENTS 01/05/16 DCM
ALL	ADJUSTED FOR NEW TOPOGRAPHICAL SURVEY 01/18/16 DCM
C500, C700, C800	REVISED PER CITIZENS COMMENTS 02/02/16 KJMJ
ALL	▲ BURGESS HILL PASS & T/C SAN. 805 STM 327 05/19/16 DCM
C200, C500, C600 & C700	AS BUILTS 12/11/16 CCE

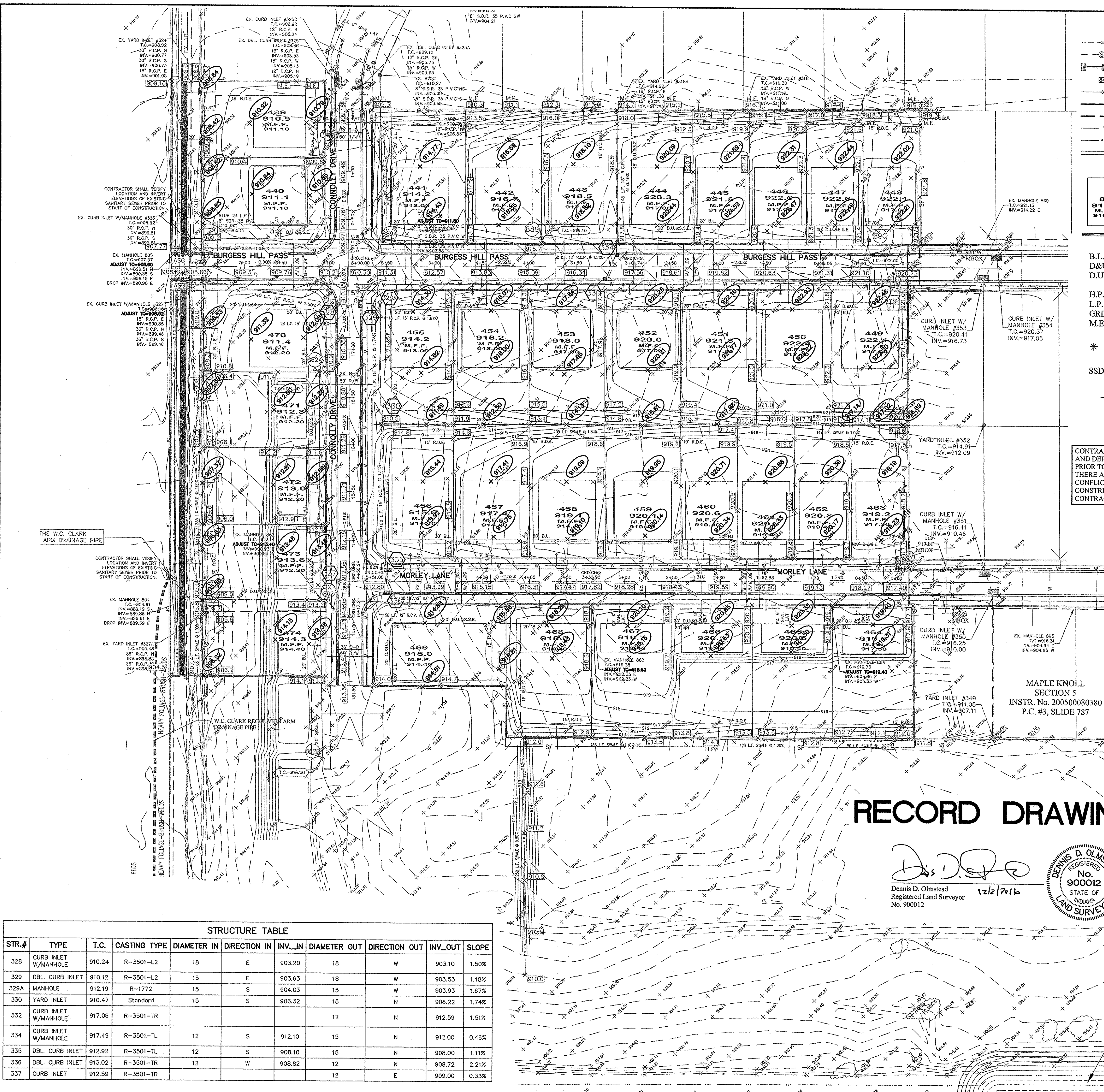

LEGEND

- - - - - EXISTING CONTOUR
- - - - - EXISTING SANITARY SEWER
- - - - - EXISTING STORM SEWER
- - - - - PROPOSED GRADE
- - - - - PROPOSED CONTOUR
- - - - - PROPOSED SANITARY SEWER
- - - - - PROPOSED STORM SEWER
- - - - - PROPOSED WATER LINE
- - - - - PROPOSED SWALE
- - - - - PROPOSED 5' SIDEWALK (BY HOME BUILDER)
(DEVELOPER SHALL INSTALL SIDEWALKS ALONG ALL COMMON AREAS)
- 85
915.0
M.F.F.
916.00
- PROPOSED 6" UNDERDRAINS
- B.L. Building Setback Line
- D.U.&S.E. Drainage & Utility Easement
- D.U.&S.E. Drainage, Utility & Sanitary Sewer Easement
- H.P. High Point
- L.P. Low Point
- GRD. CHG. Grade Change
- M.E. Match Existing
- * ADA RAMP (SEE DETAIL SHT. C803)
- SSD TO LOT
- RISER TC
- 6" SSD
- UTILITY CROSSINGS

CONTRACTOR SHALL VERIFY LOCATION AND DEPTH OF ALL EXISTING UTILITIES PRIOR TO CONSTRUCTION TO CONFIRM THERE ARE NO CROSSING CONFLICTS. CONFLICTS THAT ARE DISCOVERED AFTER CONSTRUCTION BEGINS ARE SOLELY THE CONTRACTOR'S RESPONSIBILITY.

BENCHMARK ELEVATION = 924.24 (NGVD 88)

B 112 - A STANDARD DISK, STAMPED "B 112 1946" AND SET IN THE TOP OF A CONCRETE POST PROJECT 5" ABOVE GROUND, LOCATED ALONG S.R. 32 AND 0.25 MILES EAST OF CASEY ROAD, 24 FEET NORTH OF THE CENTERLINE OF SAID HIGHWAY, 167 FEET EAST OF THE CENTERLINE OF THE DRIVEWAY LEADING TO HILL MATTHEWS FARM HOUSE, 75 FEET SOUTH EAST OF THE SOUTHEAST CORNER OF A BARN, 4 FEET EAST OF A FENCE CORNER POST.

SEE SHEET C100 FOR TBM. NO. 1 - TBM. NO. 8.

- EARTHWORK:**
- EXCAVATION**
 - A. Excavated material that is suitable may be used for fills. All unsuitable material and all surplus excavated material not required shall be removed from the site.
 - B. Provide and place any additional fill material from offsite as may be necessary to produce the grades required on plans. Fill obtained from offsite shall be of quality as specified for fills herein and the source approved by the Developer. It will be the responsibility of the Contractor for any costs for fill needed.
 - REMOVAL OF TREES**
 - A. All trees and stumps shall be removed from areas to be occupied by a road surface or structure area. Trees and stumps shall not be buried on site.
 - PROTECTION OF TREES**
 - A. The Contractor shall, at the direction of the Developer, endeavor to save and protect trees of value and worth which do not impair construction of improvements as designed.
 - B. In the event cut or fill exceeds 0.5 foot over the root area, the Developer shall be consulted with respect to protective measure to be taken, if any, to preserve such trees.
 - REMOVAL OF TOPSOIL**
 - A. All topsoil shall be removed from all areas beneath future pavements or building. Topsoil removal shall be to a minimum depth of 6 inches or to the depth indicated in the geotechnical report provided by the Developer to be excavated or filled. Topsoil should be stored at a location where it will not interfere with construction operations. The topsoil shall be free of debris and stones.
 - UTILITIES**
 - A. Rules and regulation governing the respective utility shall be observed in executing all work under this section.
 - B. It shall be the responsibility of the Contractor to determine the location of existing underground utilities 2 working days prior to commencing work. For utility locations to be marked call Toll Free 1-800-382-5544 within Indiana or 1-800-428-5200 outside Indiana.
 - SITE GRADING**
 - A. Do all cutting, filling, compacting of fills and rough grading required to bring entire project area to subgrade as shown on the drawing.
 - B. The tolerance for paved areas shall not exceed 0.05 feet above established subgrade. All other areas shall not exceed 0.05 feet plus or minus the established grade. Provide roundings at top and bottom of banks and other breaks in grade.
 - C. The Engineer shall be notified when the Contractor has reached the tolerance as stated above, so that field measurements and spot elevations can be verified by the Engineer. The Contractor shall not remove his equipment from the site until the Engineer has verified that the job meets the above tolerance.

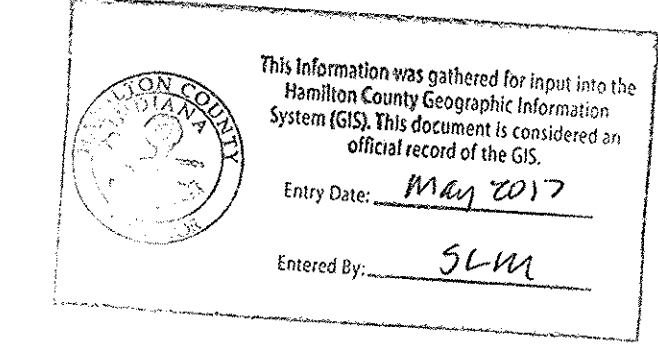

STRUCTURE TABLE										
STR.#	TYPE	T.C.	CASTING TYPE	DIAMETER IN	DIRECTION IN	INV._IN	DIAMETER OUT	DIRECTION OUT	INV._OUT	SLOPE
328	CURB INLET W/MANHOLE	910.24	R-3501-L2	18	E	903.20	18	W	903.10	1.50%
329	DBL. CURB INLET	910.12	R-3501-L2	15	E	903.63	18	W	903.53	1.18%
329A	MANHOLE	912.19	R-1772	15	S	904.03	15	W	903.93	1.67%
330	YARD INLET	910.47	Standard	15	S	906.32	15	N	906.22	1.74%
332	CURB INLET W/MANHOLE	917.06	R-3501-TR	12	S	912.10	15	N	912.59	1.51%
334	CURB INLET W/MANHOLE	917.49	R-3501-TL	12	S	912.10	15	N	912.00	0.46%
335	DBL. CURB INLET	912.92	R-3501-TL	12	S	908.10	15	N	908.00	1.11%
336	DBL. CURB INLET	913.02	R-3501-TR	12	W	908.82	12	N	908.72	2.21%
337	CURB INLET	912.59	R-3501-TR	12	E	909.00	12	E	909.00	0.33%

RECORD DRAWING

Dennis D. Olmstead
Registered Land Surveyor
No. 900012

12/2/2016

DENNIS D. OLMSTEAD
REGISTERED
No. 900012
STATE OF INDIANA
LAND SURVEYOR

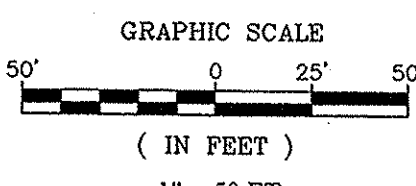

COE

AS BUILT

11/17/16

REVISIONS

DATE	MARK	REVISIONS
02/19/16	DK	REVISD PER OWNER CHANGES
02/19/16	DK	BURGESS HILL PASS & T/C SAN 805 STM. 327
02/19/16	DK	ADJUSTED FOR NEW TOPOGRAPHIC SURVEY
02/19/16	DK	REVISD PER CITY OF WESTFIELD COMMENTS
02/19/16	DK	ADDED 6" ASPHALT PATH
02/19/16	DK	REVISD PER TAC COMMENTS
02/19/16	DK	REVISD PER CITIZENS WATER & SANITARY
02/19/16	DK	REVISD PER TAC COMMENTS
02/19/16	DK	REVISD PER TAC COMMENTS

STOEPPELWERTH
REGISTERED
No. 19358
STATE OF INDIANA
PROFESSIONAL ENGINEER

THIS DRAWING IS NOT INTENDED TO BE REPRESENTED AS A RETRACTION OF ORIGINAL BOUNDARY SURVEY. A ROUTE OR A SURVEY FOR LOCATION REPORT.

CERTIFIED: 10/01/14
David J. Stoepelwerth

STOEPPELWERTH
ALWAYS ON
7905 East 106th Street, Fishers, IN 46038-2005
phone: 317.895.5935 fax: 317.895.5942

HAMILTON COUNTY, INDIANA
WESTFIELD, WASHINGTON TWP.

MAPLE KNOLL SECTION 8

811
Know what's below.
Call before you dig.

IUPPS Dig Safely.
Indiana Underground Plant Protection Service

DRAWN BY: ADG
CHECKED BY: BKR

SHEET NO. C200

S & A JOB NO. 34676PLA-58

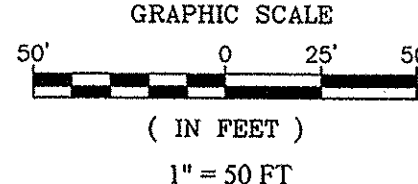
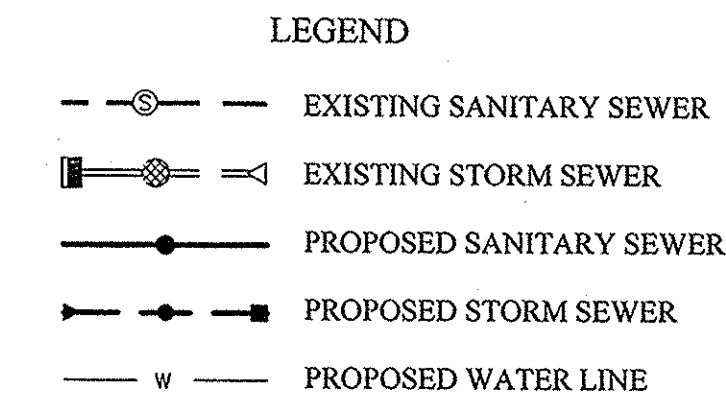
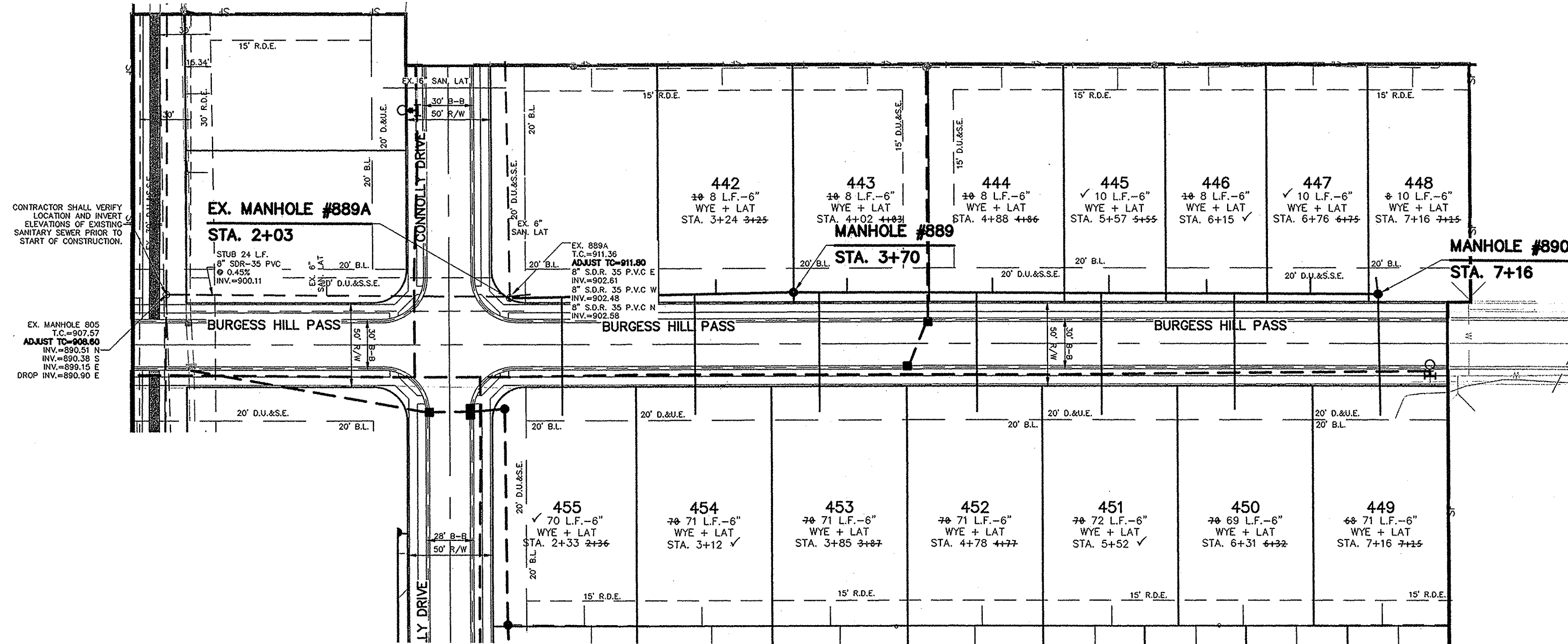

- NOTES
- 1.) MINIMUM SLOPES PER TEN STATE STANDARDS SHALL PREVAIL IN ALL CASES.
 - 2.) SEWER LATERALS SHALL EXTEND TO A POINT NO LESS THAN 5' AND NO GREATER THAN 7' FROM BUILDING LINE, AS SHOWN.
 - 3.) LATERALS SHALL BE INSTALLED NO GREATER THAN 6' BELOW PAD GRADE AT LATERAL END.
 - 4.) MANHOLE STRUCTURES TO BE CONSTRUCTED TO REQUIRE ONE-4" RISER RING, NO MORE, NO LESS TO MEET PLAN TOP OF CASTING.
 - 5.) ALL MAIN AND LATERAL ROAD CROSSINGS SHALL BE FULL DEPTH GRANULAR BACKFILL.
 - 6.) SANITARY SEWERS ARE NOT WITHIN 100' OF WATER WELLS.
 - 7.) ALL SANITARY SEWER LATERALS SHALL HAVE LOCATE WIRE RUN WHEN INSTALLING.

SCALE: 1"=50' HOR.
1"=5' VERT.

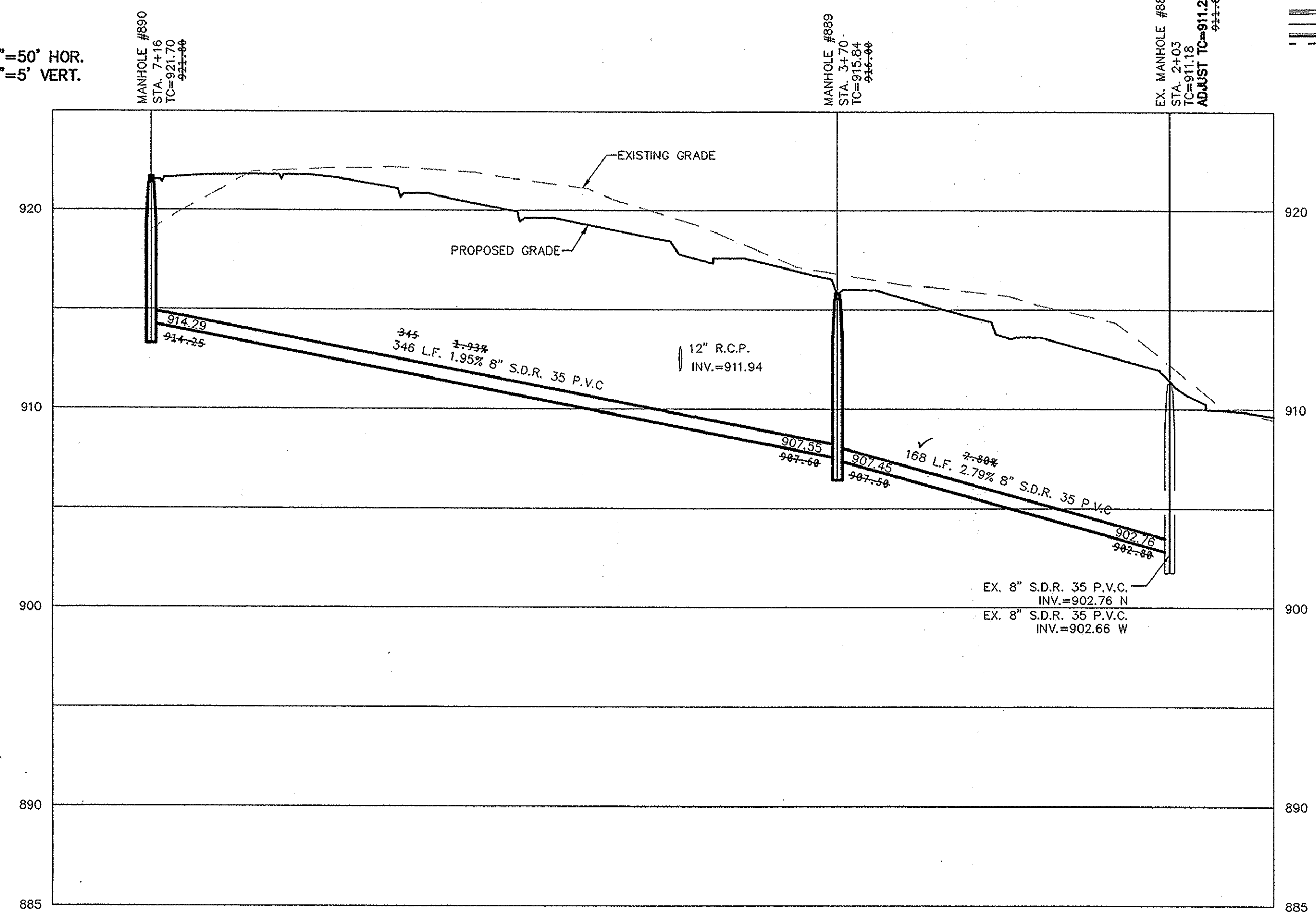

STR.#	TYPE	T.C.	CASTING TYPE	DIA. IN	DIR. IN	INV. IN	DIA. OUT	DIR. OUT	INV. OUT	SLOPE	PIPE	LENGTH	MATERIAL
862	EX. MANHOLE	913.80	EXISTING	8"	N	900.95	8"	W	900.85	2.79%	EX. 862-862A 862 E EX. 862-862B	240' 20' 141' 168'	S.D.R. 35 P.V.C. S.D.R. 35 P.V.C. S.D.R. 35 P.V.C.
862A	MANHOLE	911.30	R-1772-C				8"	S	904.00	1.27%	EX. 862-862A	240'	S.D.R. 35 P.V.C.
862B	MANHOLE	915.50	R-1772-C				8"	N	908.10	4.26%	EX. 862-862B	168'	S.D.R. 35 P.V.C.
889	MANHOLE	916.00	R-1772-C	8"	E	907.55	8"	W	907.45	2.79%	889-890 EX. 889A-889	346' 168'	S.D.R. 35 P.V.C. S.D.R. 35 P.V.C.
889A	EX. MANHOLE	911.50	EXISTING	8"	E	902.76					EX. 889A-889	168'	S.D.R. 35 P.V.C.
890	MANHOLE	921.90	R-1772-C				8"	W	914.29	1.95%	889-890	346'	S.D.R. 35 P.V.C.

This information was gathered for input into the Hamilton County Geographic Information System (GIS). This document is considered an official record of the GIS.
Entry Date: May 2017
Entered By: SLM



RECORD DRAWING

Dennis D. Olmstead
Registered Land Surveyor
No. 900012
12/2/2016

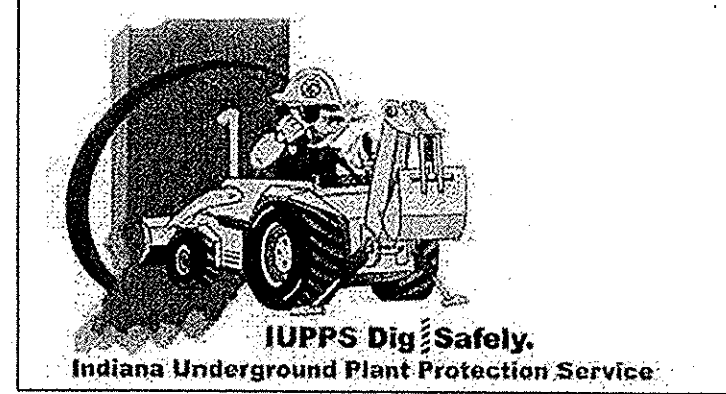
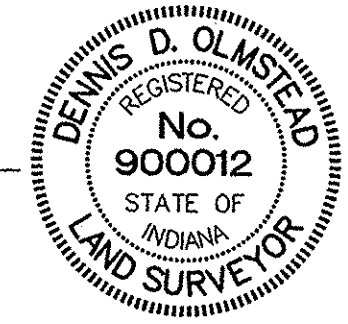

AS BUILTS

11/17/16	05/19/16	BURGESS HILL PASS & 7/4 SAN 800 STM. 327	CC
02/02/16	02/02/16	ADJUSTED PER CITIZENS COMMENTS	DKM
07/08/16	07/08/16	REVIEWED FOR NEW TOPOGRAPHICAL SURVEY	DKM
07/05/16	07/05/16	ADDED PER CITY OF WESTFIELD COMMENTS	DKM
12/12/15	12/12/15	ADDED 6" ASPHALT PATH	DKM
12/02/15	12/02/15	REVISED PER TAC COMMENTS	DKM
11/16/15	11/16/15	REVISED PER CITIZENS WATER & SANITARY	DKM
10/19/15	10/19/15	REVISED PER TAC COMMENTS	DKM
		REVISIONS	BY

THIS DRAWING IS NOT INTENDED TO BE REPRESENTED AS A RETRACEMENT OR SURVEY OR A SURVEYOR LOCATION REPORT.
CERTIFIED: 10/01/14
Daniel J. Stoepelwerth
REGISTERED PROFESSIONAL ENGINEER
No. 19358
STATE OF INDIANA

STOEPPELWERTH
ALWAYS ON
795 East 10th Street, Fishers, IN 46038-2905
phone: 317.849.3932 fax: 317.849.3942

SANITARY SEWER PLAN & PROFILE
MAPLE KNOLL SECTION 8
HAMILTON COUNTY, INDIANA
WESTFIELD, WASHINGTON TWP.

DRAWN BY: ADG
CHECKED BY: BKR
SHEET NO. C500
S & A JOB NO. 34676PLA-58

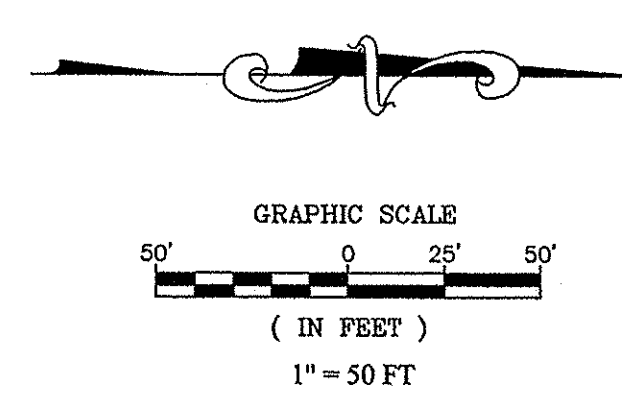
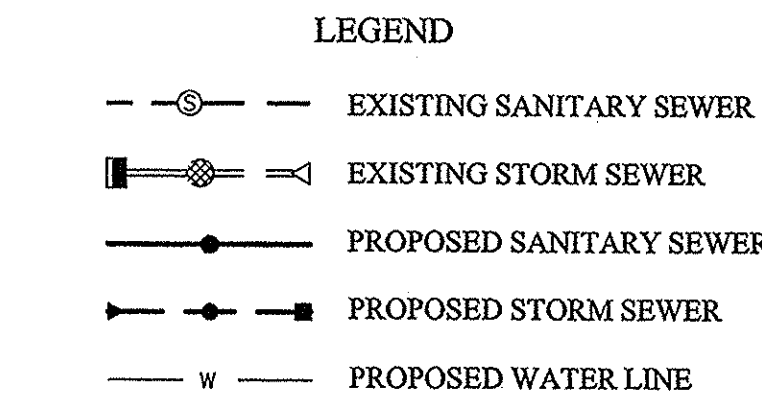
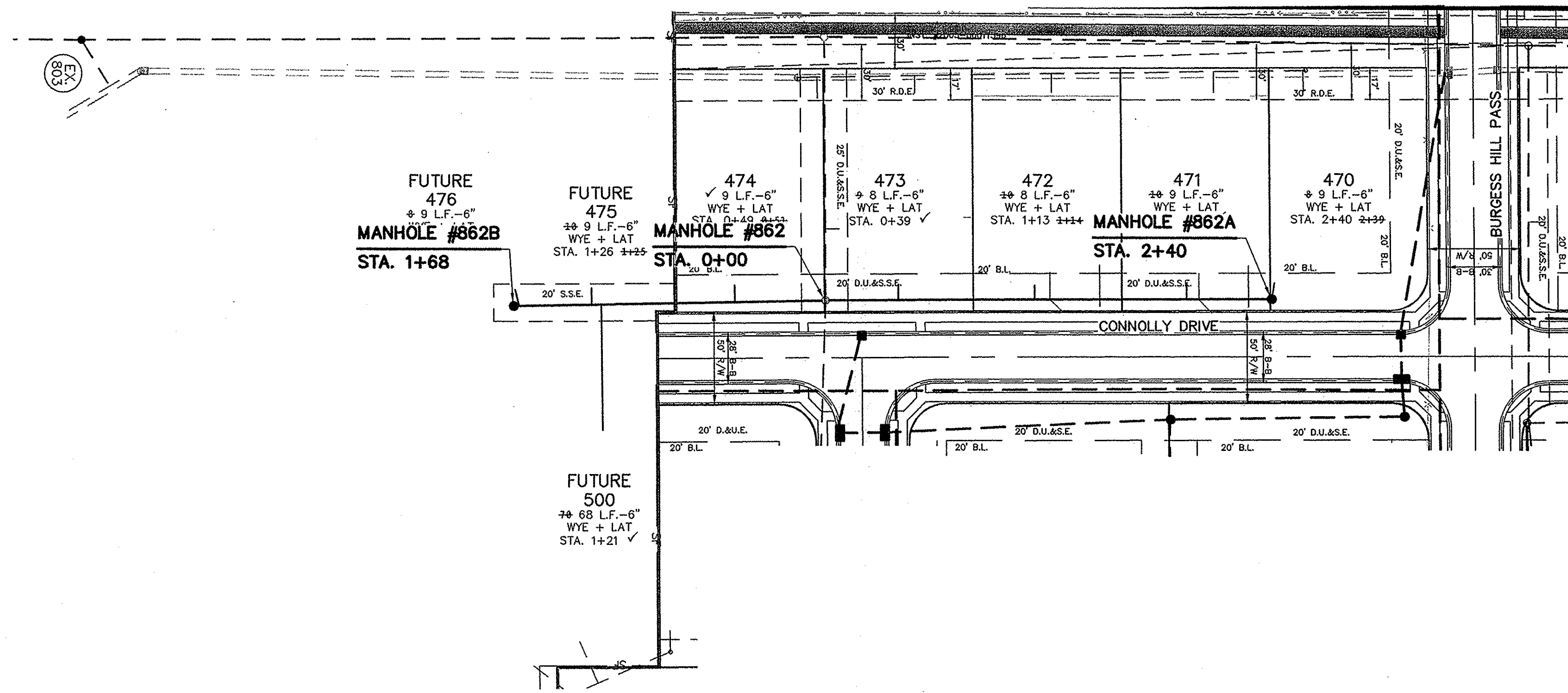

- NOTES
- 1.) MINIMUM SLOPES PER TEN STATE STANDARDS SHALL PREVAIL IN ALL CASES.
 - 2.) SEWER LATERALS SHALL EXTEND TO A POINT NO LESS THAN 5' AND NO GREATER THAN 7' FROM BUILDING LINE, AS SHOWN.
 - 3.) LATERALS SHALL BE INSTALLED NO GREATER THAN 6' BELOW PAD GRADE AT LATERAL END.
 - 4.) MANHOLE STRUCTURES TO BE CONSTRUCTED TO REQUIRE ONE-4" RISER RING, NO MORE, NO LESS TO MEET PLAN TOP OF CASTING.
 - 5.) ALL MAIN AND LATERAL ROAD CROSSINGS SHALL BE FULL DEPTH GRANULAR BACKFILL.
 - 6.) SANITARY SEWERS ARE NOT WITHIN 100' OF WATER WELLS.
 - 7.) ALL SANITARY SEWER LATERALS SHALL HAVE LOCATE WIRE RUN WHEN INSTALLING.

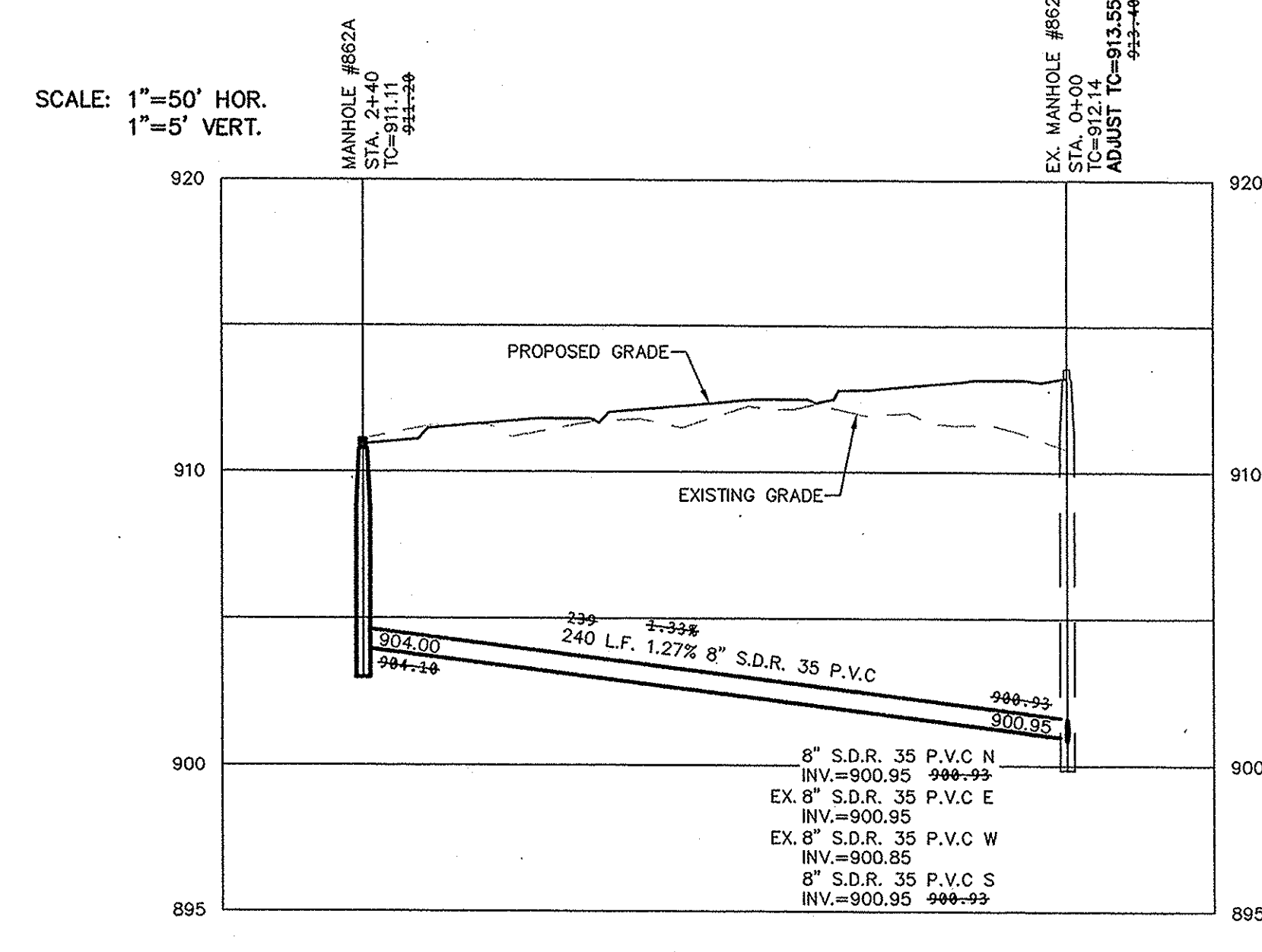
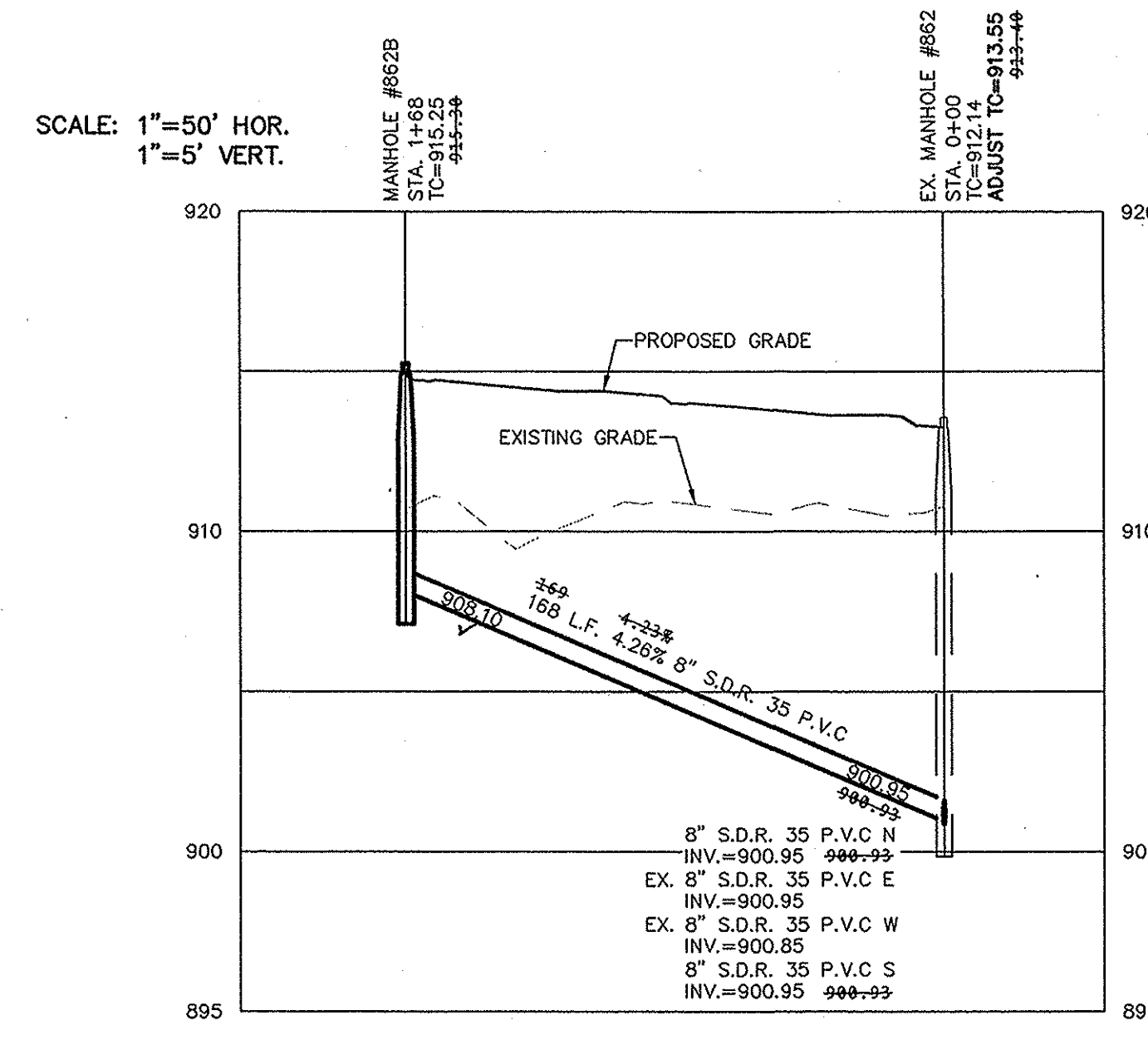

This information was gathered for input into the Hamilton County Geographic Information System (GIS). This document is considered an official record of the GIS.
 Entry Date: May 2017
 Entered By: slm



RECORD DRAWING

Dennis D. Olmstead
 Registered Land Surveyor
 No. 900012
 12/2/2016

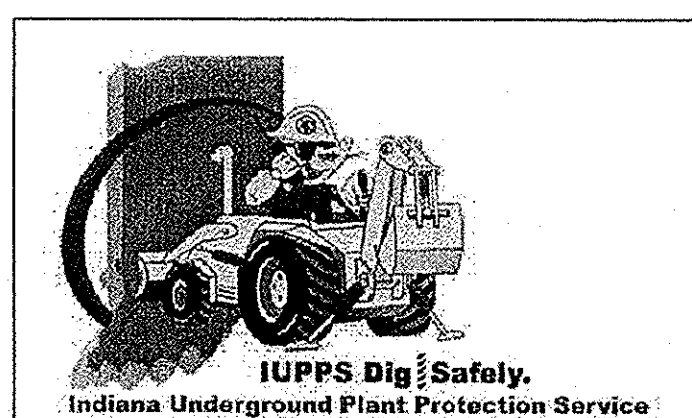
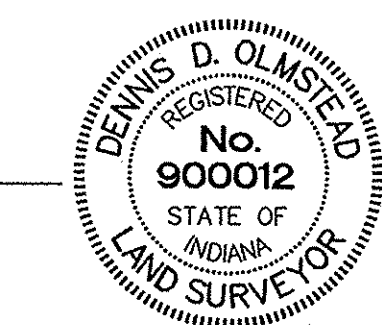

CCE	AS BUILTS	11/17/16	11/17/16
DCM	BURGESS HILL PASS & T/C SAN 806 STM 327	05/19/16	05/19/16
DCM	ADJUSTED FOR NEW TOPOGRAPHICAL SURVEY	07/19/16	07/19/16
DCM	RECEIVED PER CITY OF WESTFIELD COMMENTS	07/25/16	07/25/16
DCM	ADDED 6" ASPHALT PATH	07/27/16	07/27/16
DCM	REVISED PER TAC COMMENTS	07/27/16	07/27/16
DCM	REVISED PER CITIZENS WATER & SANITARY	11/16/16	11/16/16
DCM	REVISED PER TAC COMMENTS	10/19/16	10/19/16
BY	REVISIONS	MARK	DATE

THIS DRAWING IS NOT INTENDED TO BE REPRESENTED AS A RETRACTION OR ORIGINAL BOUNDARY SURVEY. A ROUTE SURVEY OR A SURVEYOR LOCATION REPORT.

CERTIFIED: 10/01/14
 David J. Stoepelwerth
 REGISTERED PROFESSIONAL ENGINEER
 No. 19358
 STATE OF INDIANA

STOEPPELWERTH
 ALWAYS ON
 7905 East 106th Street, Fishers, IN 46038-2505
 phone: 317.492.5195 fax: 317.491.5192

SANITARY SEWER PLAN & PROFILE
MAPLE KNOLL SECTION 8
 HAMILTON COUNTY, INDIANA
 WESTFIELD, WASHINGTON TWP.

DRAWN BY: ADG
 CHECKED BY: BKR
 SHEET NO. C501
 S & A JOB NO. 34676PLA-S8

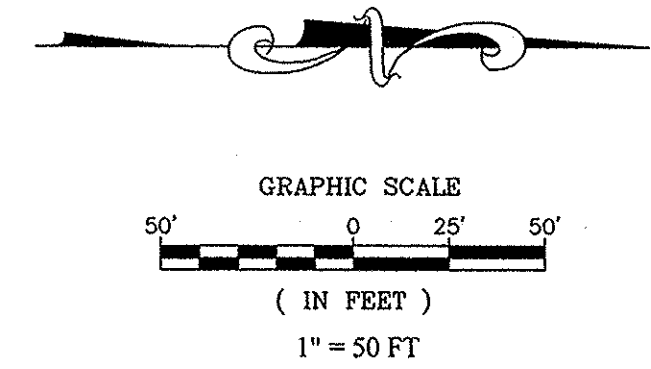
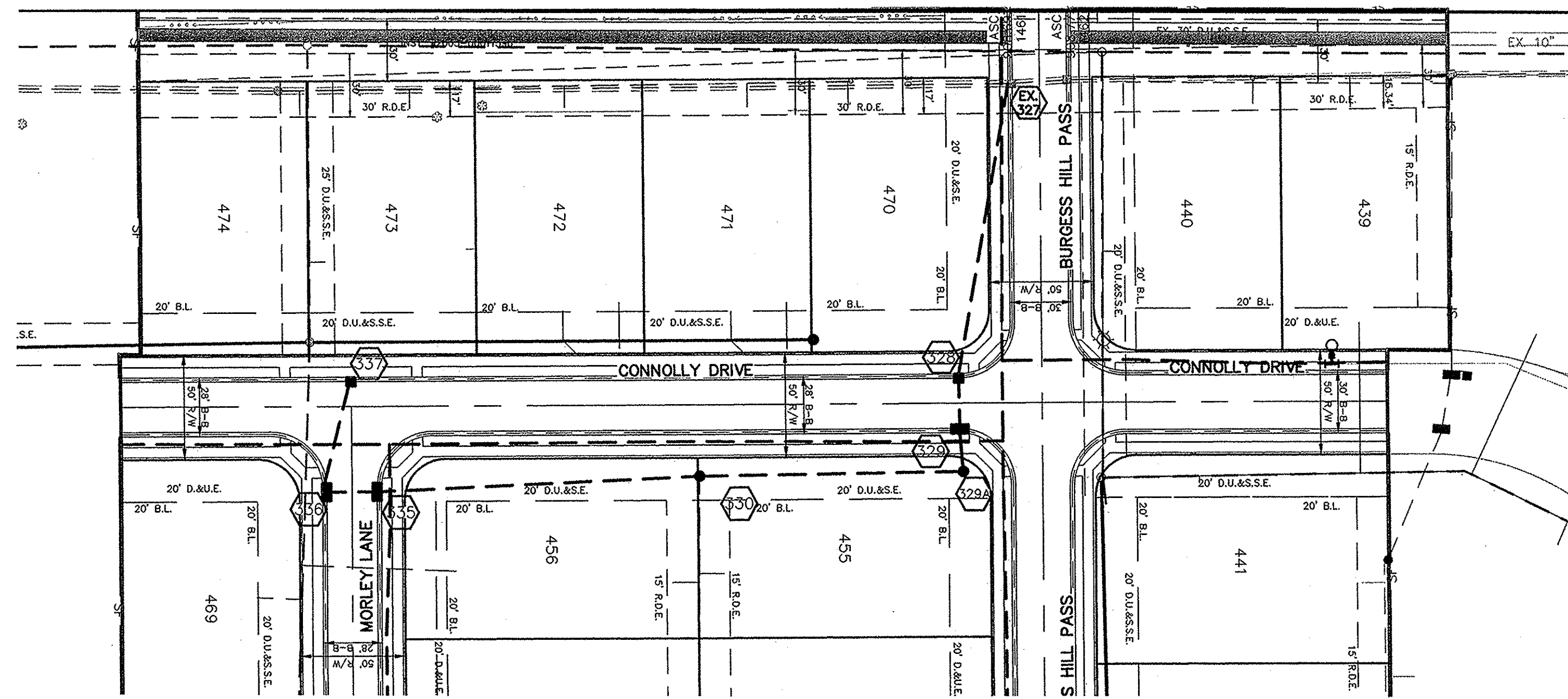

- LEGEND
- EXISTING SANITARY SEWER
 - EXISTING STORM SEWER
 - PROPOSED SANITARY SEWER
 - PROPOSED STORM SEWER
 - w--- PROPOSED WATER LINE

■ DENOTES FULL DEPTH GRANULAR BACKFILL

NOTES:

ALL STORM STRUCTURES TO RECEIVE SOLID LID CASTINGS ARE TO BE CONSTRUCTED TO PROVIDE ONE 4" RISER RING NO MORE, NO LESS TO ACHIEVE PLAN RIM GRADE.

ALL YARD INLETS ARE TO BE CONSTRUCTED AT A TOLERANCE OF +0.00' TO -0.20' OF PLAN GRADE.

ALL STORM SEWER CASTINGS SHALL BE LABELED "DUMP NO WASTE-DRAINS TO WATERWAY"

ALL STORM CROSSINGS IN RIGHT OF WAY WITH LESS THAN 30" COVER TO FINISH PAVEMENT GRADE WILL BE BACKFILLED WITH #8 STONE
 ALL SSD'S (SUBSURFACE DRAINS) WILL NEED TO BE 6" DOUBLE WALL SMOOTH BORE PERFORATED (HDPE) PIPE.
 DEBRIS GUARDS ARE TO BE INSTALLED ON ALL OPEN ENDED INLETS.

ALL STORM, INCLUDING SSD, TO BE CLEANED AND TELEVISED AFTER ALL UNDERGROUND UTILITIES ARE INSTALLED.

STORM STRUCTURES DEEPER THAN 4' MUST BE ACCESSIBLE WITH STEPS.

ALL BEEHIVE CASTINGS ON A 2'x2' BOX SHALL HAVE A SQUARE RISER WITH A ROUND HOLE.

SCALE: 1"=50' HOR.
 1"=5' VERT.

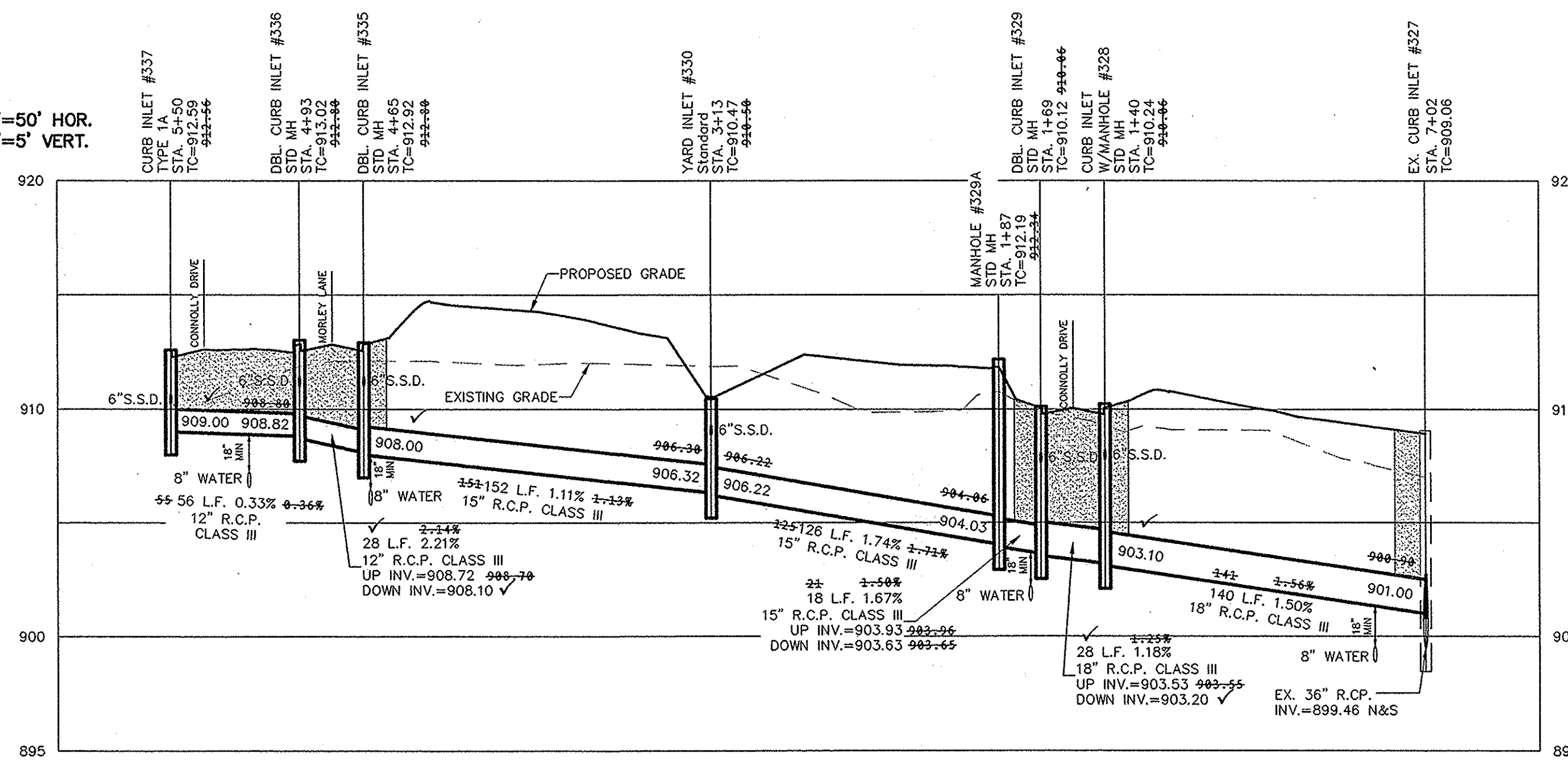

This information was gathered for input into the Hamilton County Geographic Information System (GIS). This document is considered an official record of the GIS.
 Entry Date: May 2017
 Entered By: SLM



Know what's below.
 Call before you dig.

RECORD DRAWING

D.D.O.
 Dennis D. Olmstead
 Registered Land Surveyor
 No. 900012

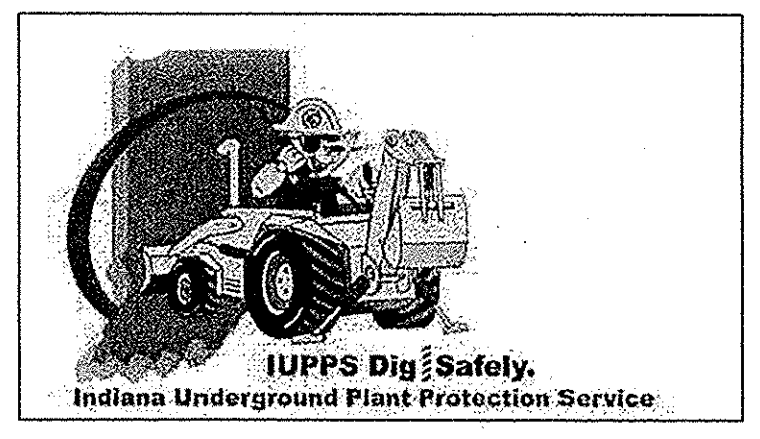
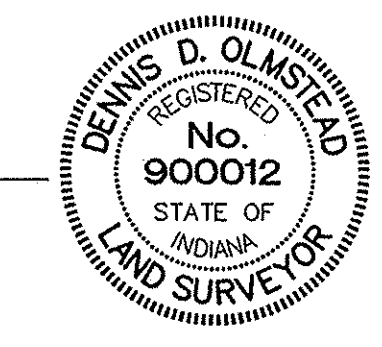

STORM SEWER PLAN & PROFILE
 MAPLE KNOLL
 SECTION 8
 WESTFIELD, WASHINGTON TWP.
 HAMILTON COUNTY, INDIANA

DRAWN BY: ADG
 CHECKED BY: BKR
 SHEET NO.: C600
 S & A JOB NO.: 34676PLA-S8

DATE	MARK	REVISIONS	BY
11/17/15		AS BUILTS	KJM
07/16/15		ADJUSTED FOR NEW TOPOGRAPHICAL SURVEY	DKM
07/16/15		REVISED PER CITY OF WESTFIELD COMMENTS	DKM
07/16/15		ADDED 6" ASPHALT PATH	DKM
12/02/15		REVISED PER TAC COMMENTS	GEN
11/16/15		REVISED PER CITIZENS WATER & SANITARY	DKM
10/19/15		REVISED PER TAC COMMENTS	KJM

STOEPELWERTH
 ALWAYS ON
 796 East 10th Street, Fishers, IN 46038-2515
 phone: 317.849.5985 fax: 317.849.5942

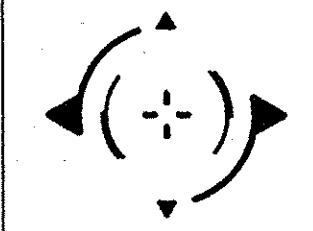

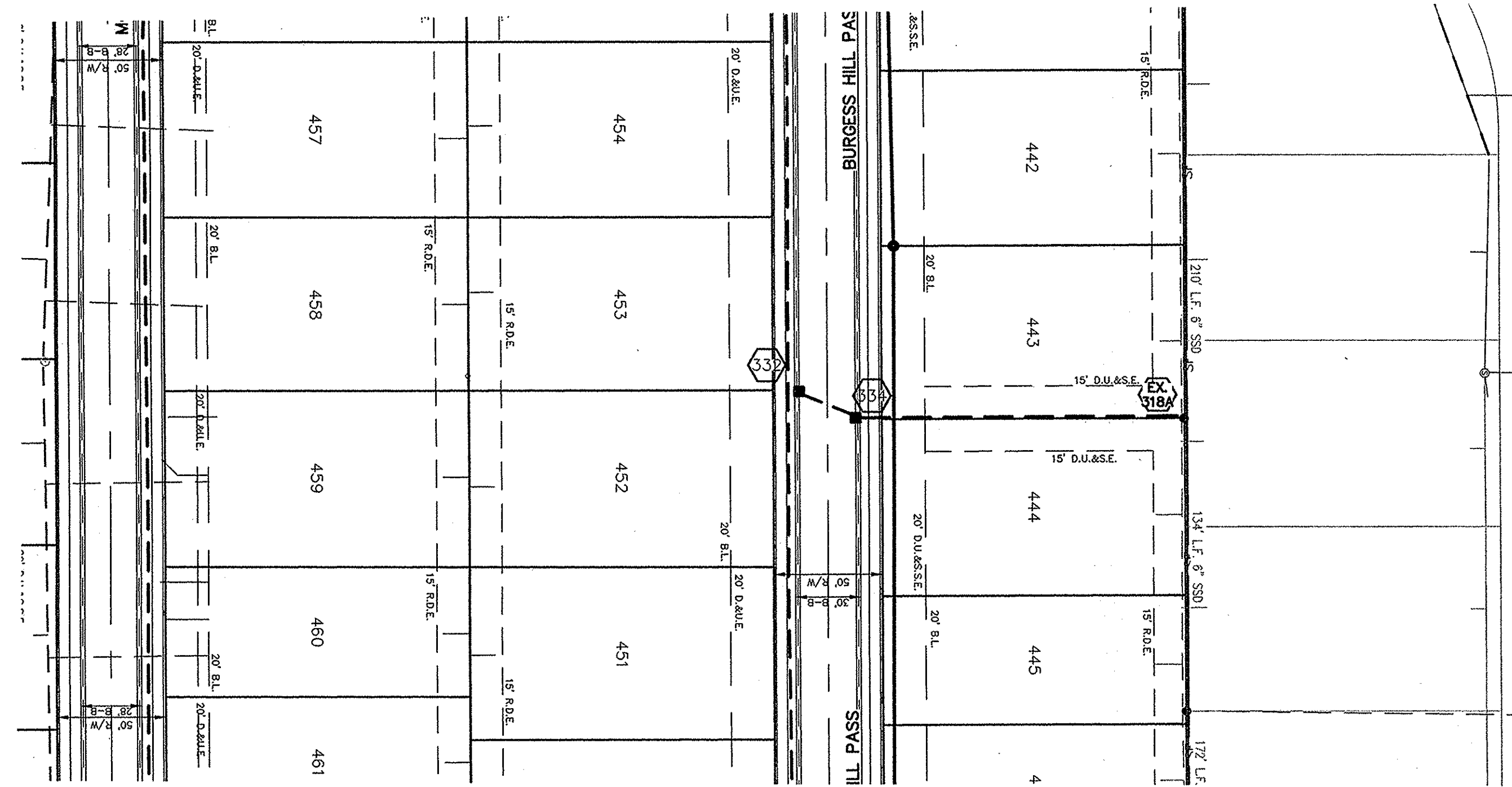

- LEGEND
- EXISTING SANITARY SEWER
 - EXISTING STORM SEWER
 - PROPOSED SANITARY SEWER
 - PROPOSED STORM SEWER
 - PROPOSED WATER LINE

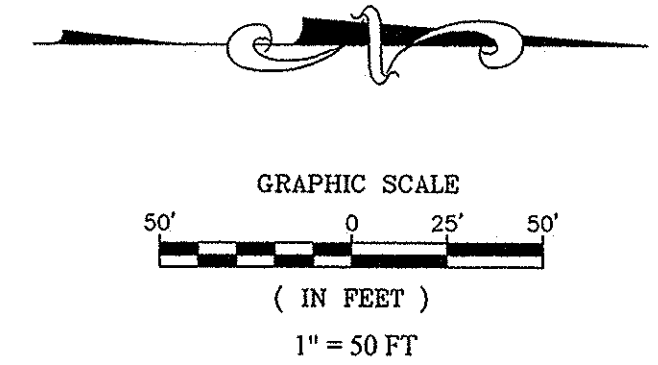

DENOTES FULL DEPTH GRANULAR BACKFILL

- NOTES:
- ALL STORM STRUCTURES TO RECEIVE SOLID LID CASTINGS ARE TO BE CONSTRUCTED TO PROVIDE ONE 4" RISER RING NO MORE, NO LESS TO ACHIEVE PLAN RIM GRADE.
 - ALL YARD INLETS ARE TO BE CONSTRUCTED AT A TOLERANCE OF +0.00' TO -0.20' OF PLAN GRADE.
 - ALL STORM SEWER CASTINGS SHALL BE LABELED "DUMP NO WASTE-DRAINS TO WATERWAY"
 - ALL STORM CROSSINGS IN RIGHT OF WAY WITH LESS THAN 30" COVER TO FINISH PAVEMENT GRADE WILL BE BACKFILLED WITH #8 STONE
 - ALL SSD'S (SUBSURFACE DRAINS) WILL NEED TO BE 6" DOUBLE WALL SMOOTH BORE PERFORATED (HDPE) PIPE.
 - DEBRIS GUARDS ARE TO BE INSTALLED ON ALL OPEN ENDED INLETS.
 - ALL STORM, INCLUDING SSD, TO BE CLEANED AND TELEVISED AFTER ALL UNDERGROUND UTILITIES ARE INSTALLED.
 - STORM STRUCTURES DEEPER THAN 4' MUST BE ACCESSIBLE WITH STEPS.
 - ALL BEEHIVE CASTINGS ON A 2x2' BOX SHALL HAVE A SQUARE RISER WITH A ROUND HOLE.

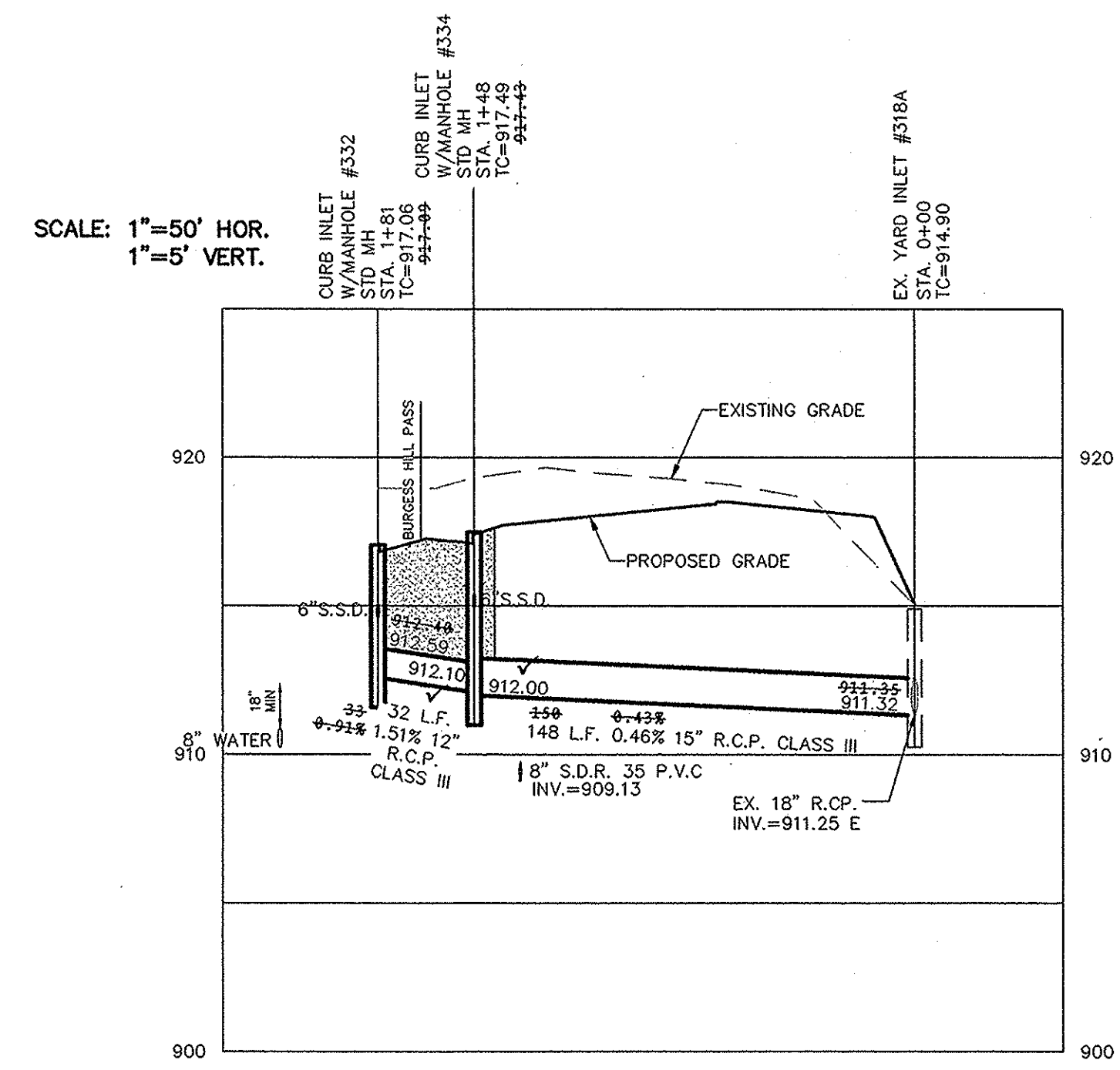

This information was gathered for input into the Hamilton County Geographic Information System (GIS). This document is considered an official record of the GIS.
 Entry Date: May 2017
 Entered By: SLM

RECORD DRAWING

811
 Know what's below.
 Call before you dig.

D.D.O.
 Dennis D. Olmstead
 Registered Land Surveyor
 No. 900012
 12/2/2016

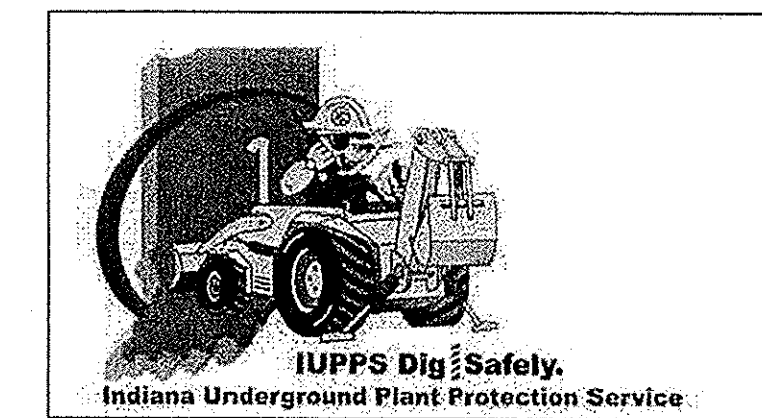

STORM SEWER PLAN & PROFILE
 MAPLE KNOLL
 SECTION 8
 WESTFIELD, WASHINGTON TWP., HAMILTON COUNTY, INDIANA

DRAWN BY: ADG
 CHECKED BY: BKR
 SHEET NO. C601
 S & A JOB NO. 34676PLA-S8

THIS DRAWING IS NOT INTENDED TO BE ORIGINAL BOUNDARY SURVEY, A ROUTE SURVEY OR A SURVEYOR LOCATION REPORT.
 CERTIFIED: 10/01/14
David J. Stoppelwerth
 REGISTERED PROFESSIONAL ENGINEER
 No. 19358
 STATE OF INDIANA

DATE	MARK	REVISIONS
11/17/16		AS BUILT'S
10/19/16		ADJUSTED FOR NEW TOPOGRAPHICAL SURVEY
10/05/16		REVISED PER CITY OF WESTFIELD COMMENTS
12/02/15		REVISED PER TAC COMMENTS
11/16/15		REVISED PER CITIZENS WATER & SANITARY
10/19/15		REVISED PER TAC COMMENTS

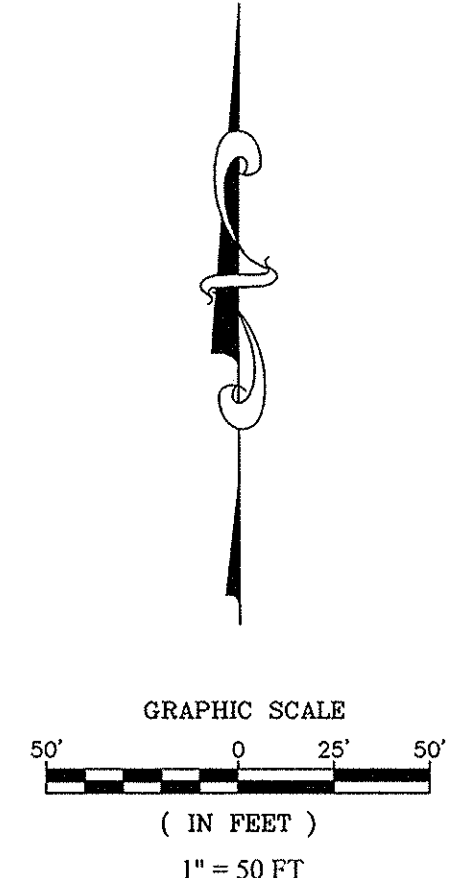
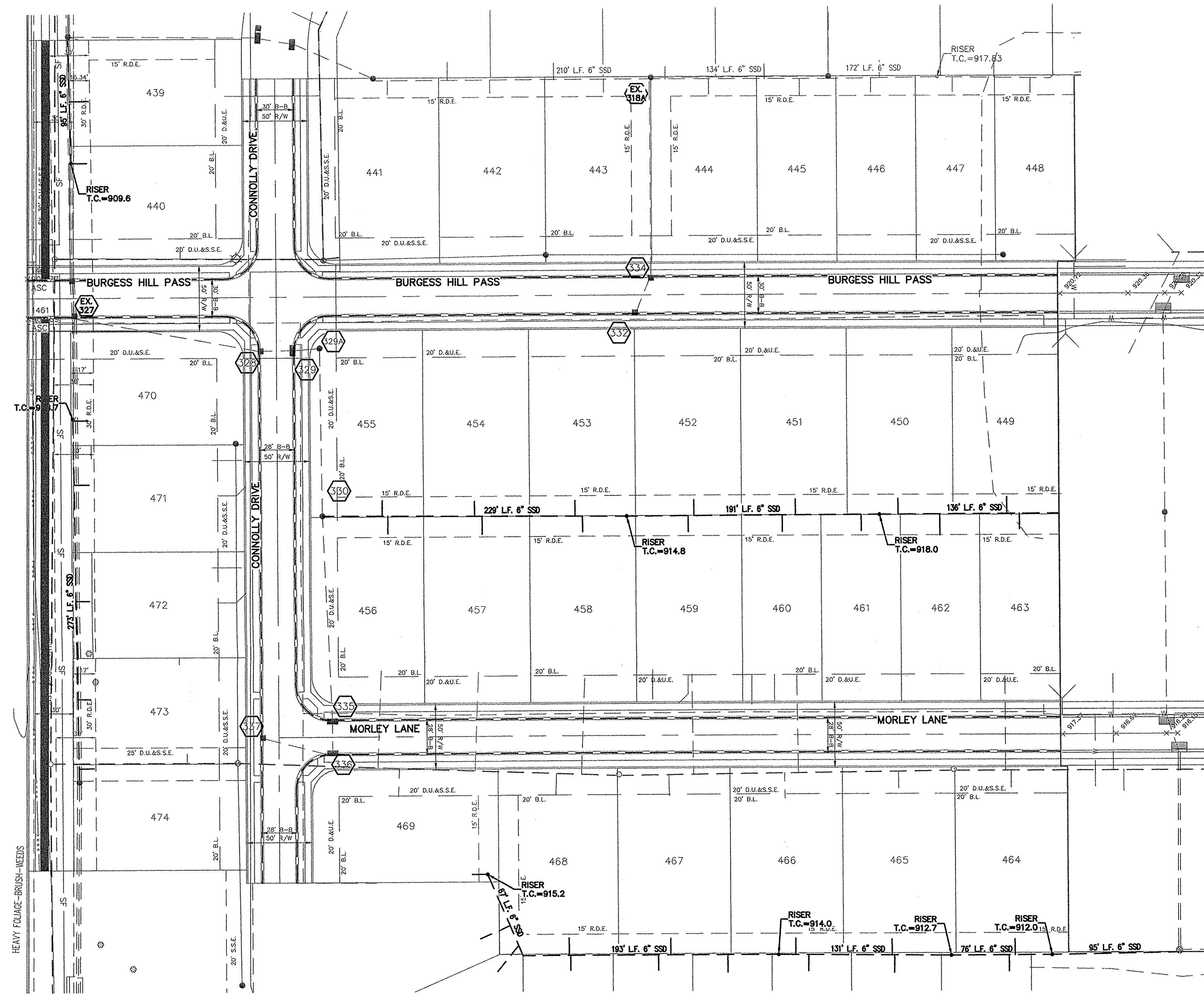

This information was gathered for input into the Hamilton County Geographic Information System (GIS). This document is considered an official record of the GIS.
 Entry Date: Mar 2017
 Entered By: SLM

RECORD DRAWING

811
 Know what's below.
 Call before you dig.

D.D.O.
 Dennis D. Olmstead
 Registered Land Surveyor
 No. 900012
 12/2/2016

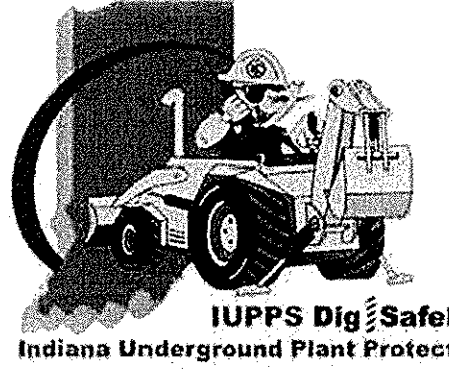

DATE	MARK	REVISIONS
11/17/16		AS BUILTS
01/18/16		ADJUSTED FOR NEW TOPOGRAPHICAL SURVEY
01/18/16		REVISED PER CITY OF WESTFIELD COMMENTS
12/10/15		ADDED 6" ASPHALT PATH
12/02/15		REVISED PER TAC COMMENTS
11/16/15		REVISED PER CITIZENS WATER & SANITARY
10/19/15		REVISED PER TAC COMMENTS

THIS DRAWING IS NOT INTENDED TO BE REPRESENTED AS A RETRACEMENT OR ORIGINAL BOUNDARY SURVEY, A ROUTE REPORT OR A SURVEYOR LOCATION REPORT.
 CERTIFIED: 10/01/14
David J. Stoepelwirth
 David J. Stoepelwirth
 No. 19358
 STATE OF INDIANA
 PROFESSIONAL ENGINEER

STOEPPELWERTH
 ALWAYS ON
 7905 East 106th Street, Fishers, IN 46038-2995
 phone: 317.849.5935 fax: 317.849.5942

SUB SURFACE DRAIN PLAN
 MAPLE KNOLL SECTION 8
 HAMILTON COUNTY, INDIANA
 WESTFIELD, WASHINGTON TWP.
 DRAWN BY: ADG CHECKED BY: BKR
 SHEET NO. C602
 S & A JOB NO. 34676PLA-S8

AS BUILTS	11/07/06
REVISED PER OWNER CHANGES	02/16/06
REVISED PER CITIZENS COMMENTS	02/17/06
ADJUSTED FOR NEW TOPOGRAPHICAL SURVEY	07/19/06
REVISED PER CITY OF WESTFIELD COMMENTS	07/19/06
ADDED 6" ASPHALT PATH	12/10/06
REVISED PER TAC COMMENTS	12/02/06
REVISED PER CITIZENS WATER & SANITARY	11/16/06
REVISED PER TAC COMMENTS	10/19/06
DATE	
MARK	

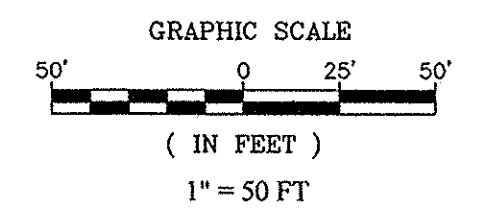
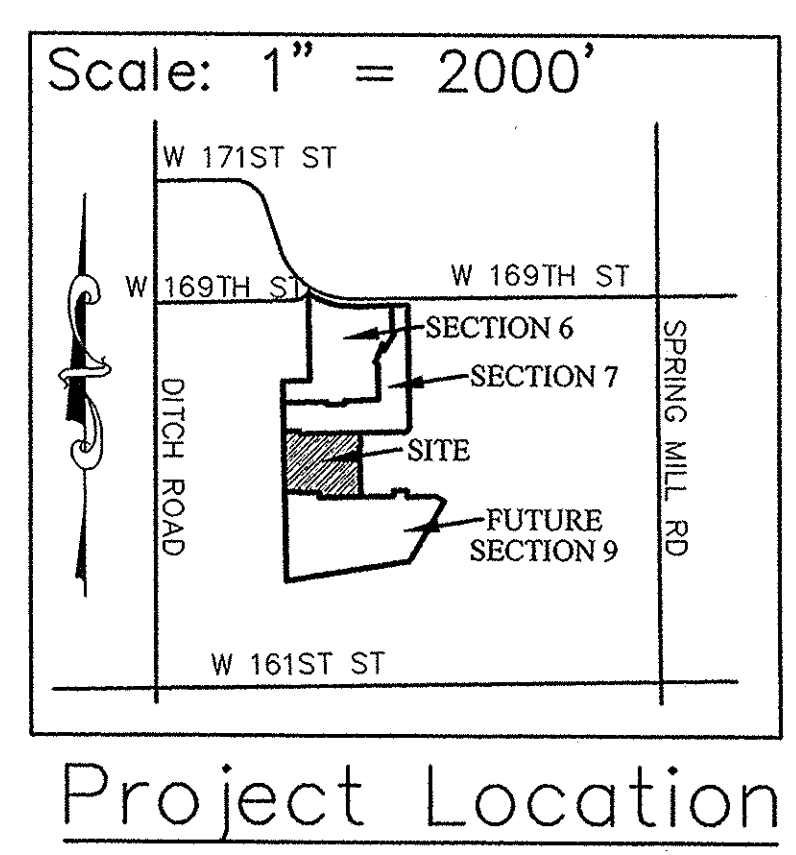

- NOTES:
- CONTRACTOR MUST HAVE AND FOLLOW CITIZENS WESTFIELD AND CITIZENS WATER STANDARDS AND SPECIFICATIONS (LATEST VERSION)
 - SEE CITIZENS WATER STANDARDS FOR THE INSTALLATION OF WATER MAINS, SERVICE LINES, METERS AND APPURTENANCES LATEST VERSION.
 - MINIMUM COVER OVER TOP OF ALL WATER MAINS TO BE 54" FROM FINISH GRADE.
 - FIRE HYDRANTS SHALL HAVE A 5-INCH STORZ'S CONNECTION INSTALL.
 - VALVES TO BE PLACED IN GRASS AREAS.
 - ALL SERVICE AND MAIN ROAD CROSSINGS WITHIN 5' OF PAVEMENT SHALL HAVE GRANULAR BACKFILL.
 - ALL HYDRANTS TO HAVE 2 COATS RED EPOXY PAINT, MUELLER P63 RL15
 - VALVES MUST HAVE POSI-CAP - (W-6) (W-7) HYDRANT
 - THE WATER MAIN MUST MAINTAIN A MINIMUM OF 10 FEET OF SEPARATION WITH THE SEWER MAIN AT ALL TIMES.

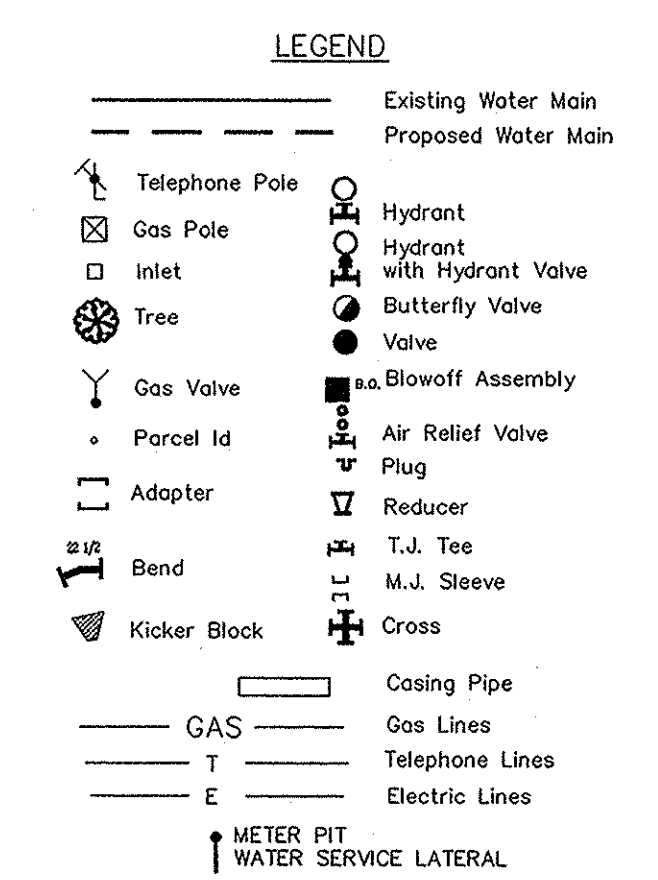

CITIZENS WATER PROJECT LEGEND				
Project Name: MAPLE KNOLL, SECTION 8				
Project Number: WFJ-16002				
JOB #	Street Name	Pipe Size	Pipe Type	Total Pipe
1	BURGESS HILL PASS	8"	PVC	763' ±±±
1	BURGESS HILL PASS	8"	D.I.	150'
2	CONNOLLY DRIVE	8"	PVC	604' ±±±
2	CONNOLLY DRIVE	8"	D.I.	54'
3	MORLEY LANE	8"	PVC	561' ±±±
3	MORLEY LANE	8"	D.I.	54'
# of Service Lines			TOTAL	1,928' ±±±±±
36	✓	1"	HDPE	1,046' ±±±±±

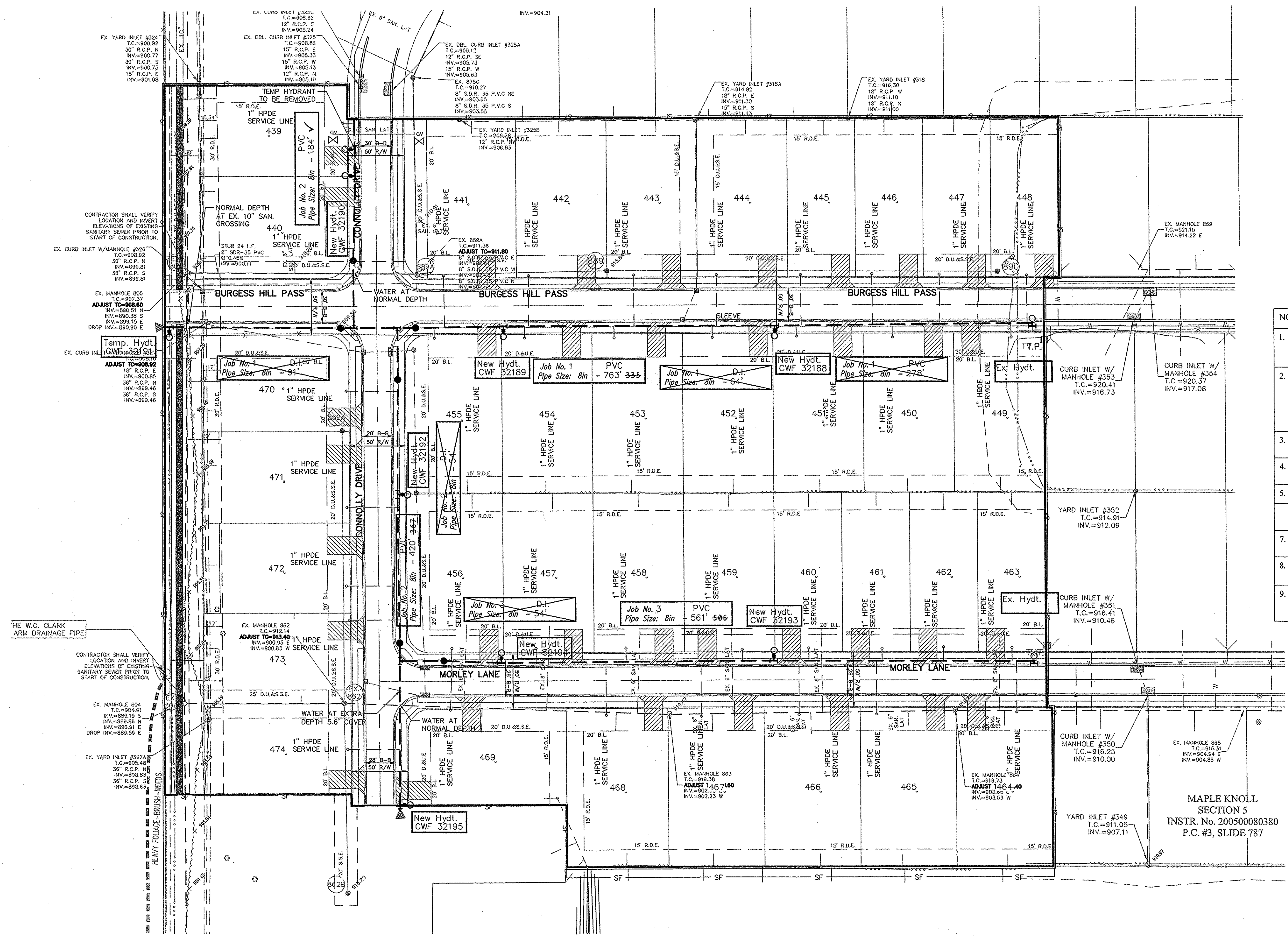

This information was gathered for input into the Hamilton County Geographic Information System (GIS). This document is considered an official record of the GIS.
 Entry Date: May 2017
 Entered By: slm

RECORD DRAWING

D.D.O.
 Dennis D. Olmstead
 Registered Land Surveyor
 No. 900012
 12/2/2016

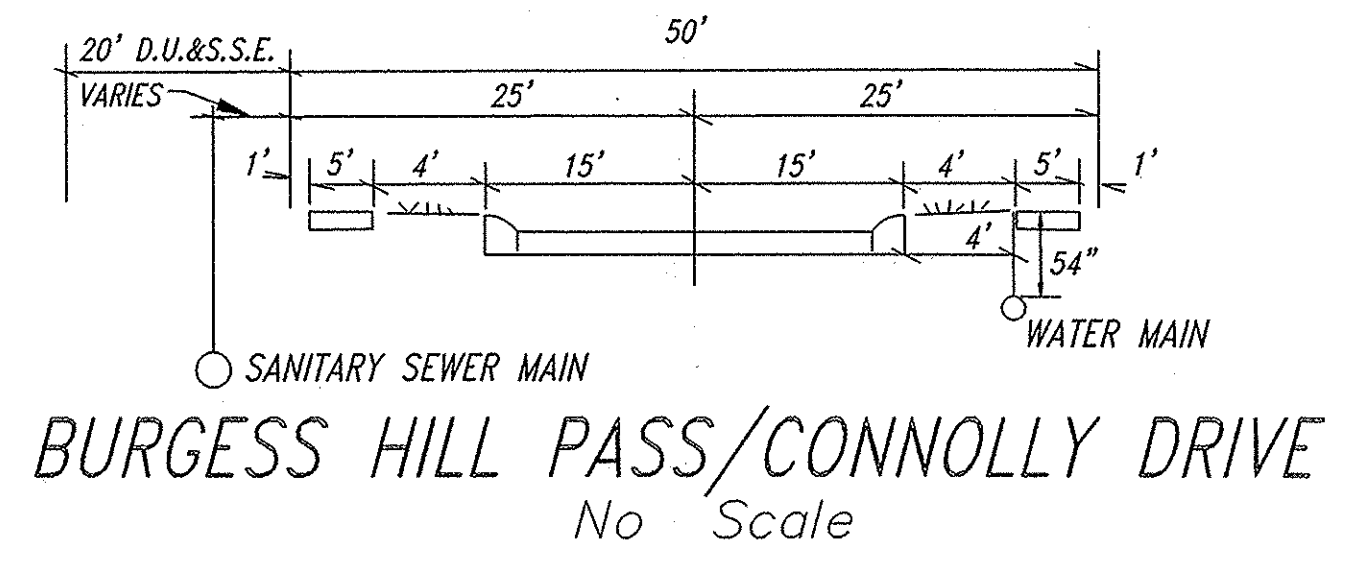
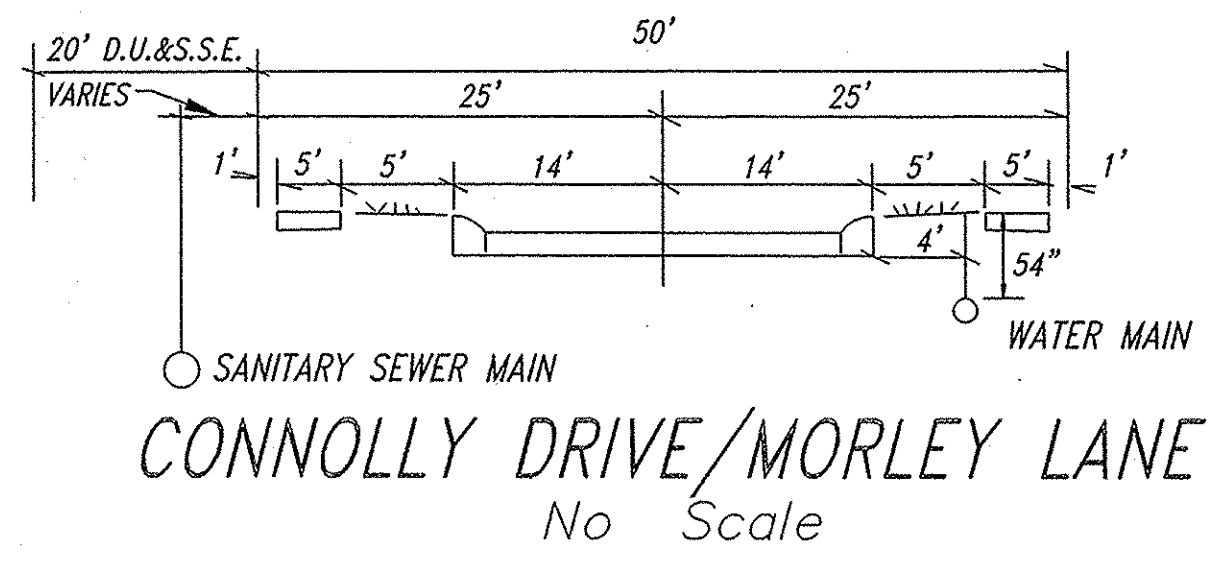
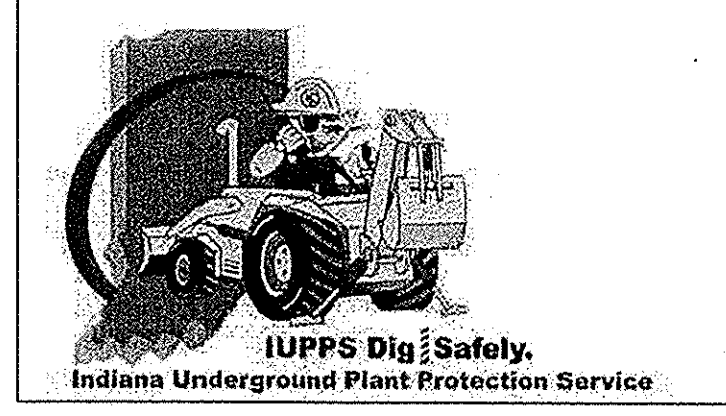
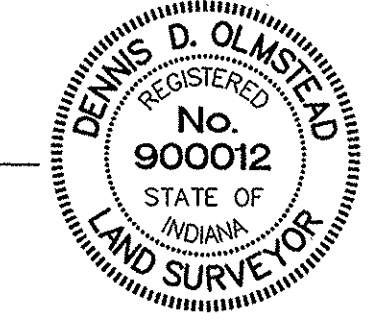

STOEPPELWERTH
 ALWAYS ON
 7945 East 100th Street, Fishers, IN 46038-2505
 phone 317.845.5935 fax 317.845.5942

WATER PLAN
MAPLE KNOLL SECTION 8
 HAMILTON COUNTY, INDIANA
 WESTFIELD, WASHINGTON TWP.

DRAWN BY: ADG CHECKED BY: BKR
 SHEET NO. C700
 S & A JOB NO. 34676PLA-58